

Joseph Lstiburek, Ph.D., P.Eng, ASHRAE Fellow

Building Science

Adventures In Building Science

www.buildingscience.com

Vapor Pressure and Relative Humidity

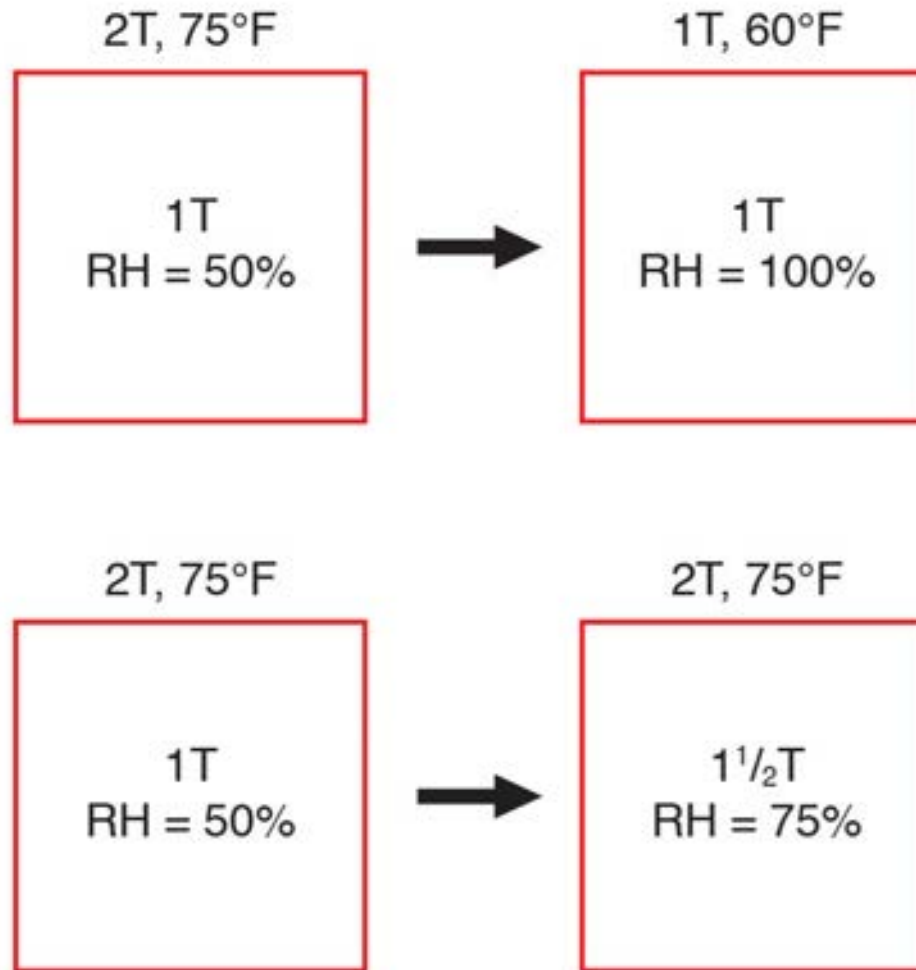

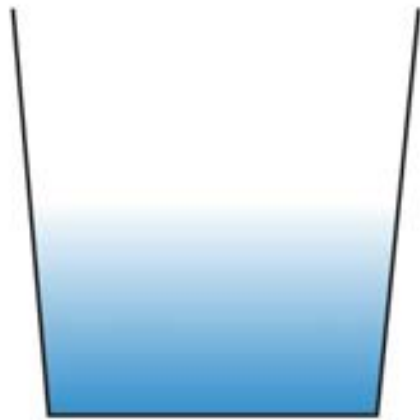

90°F
50% RH

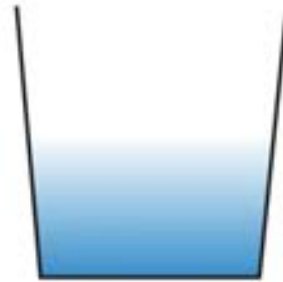

75°F
50% RH



60°F
50% RH



45°F
50% RH



30°F
50% RH

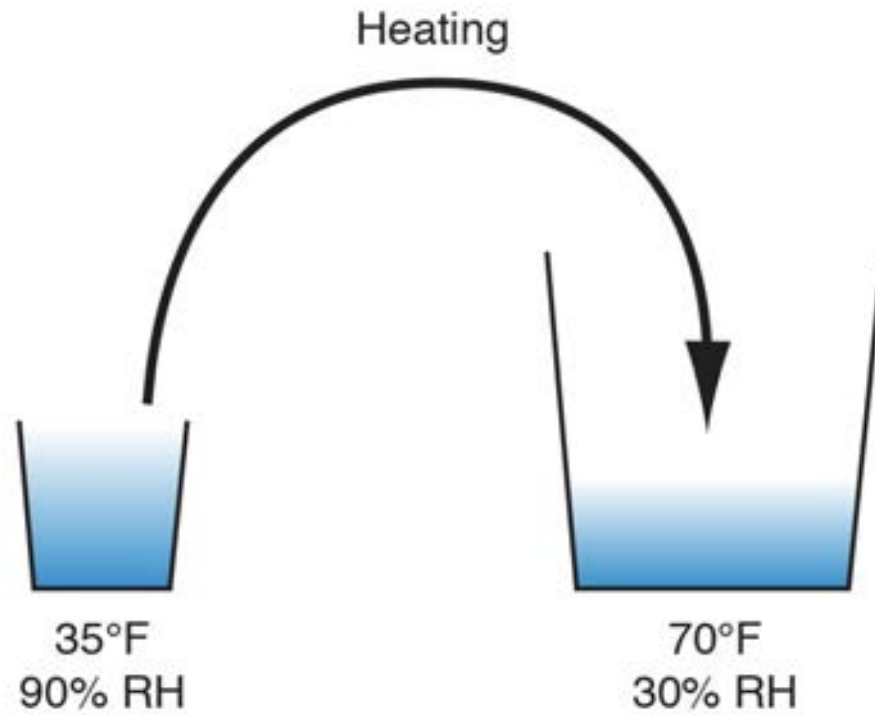

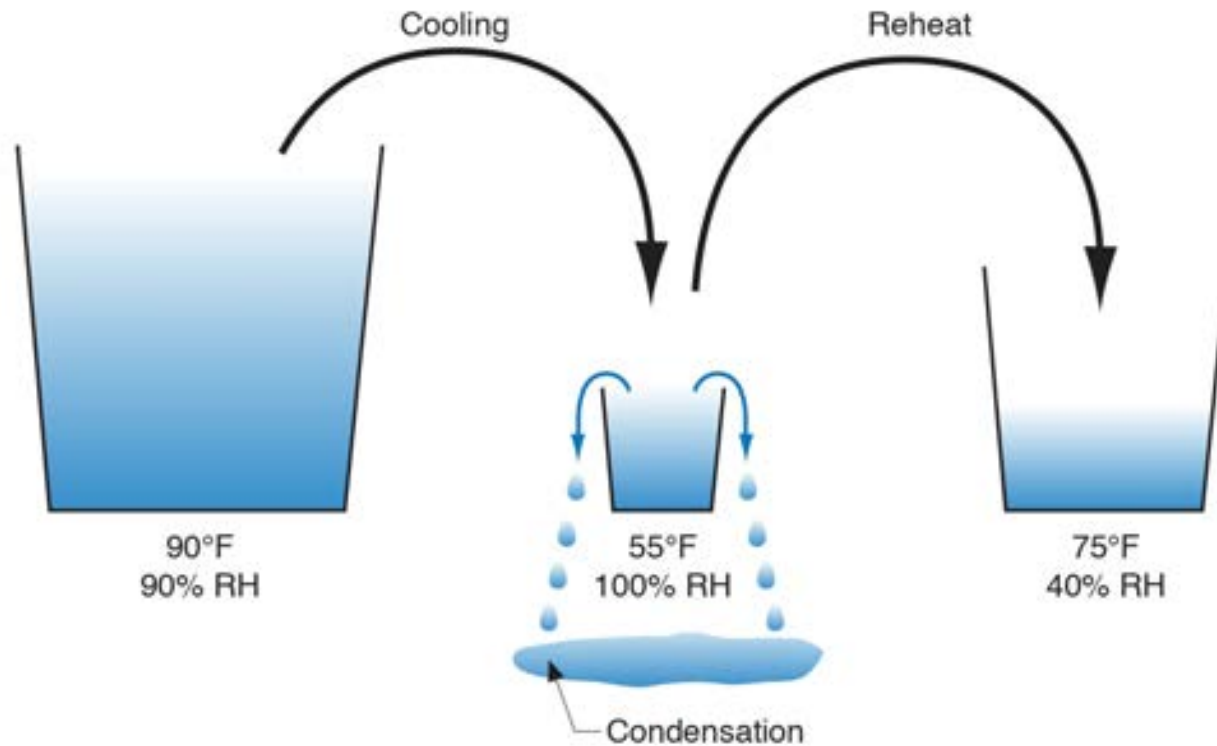



PSYCHROMETRIC CHART

NORMAL TEMPERATURES

SI METRIC UNITS

Barometric Pressure 101.325 kPa

SEA LEVEL

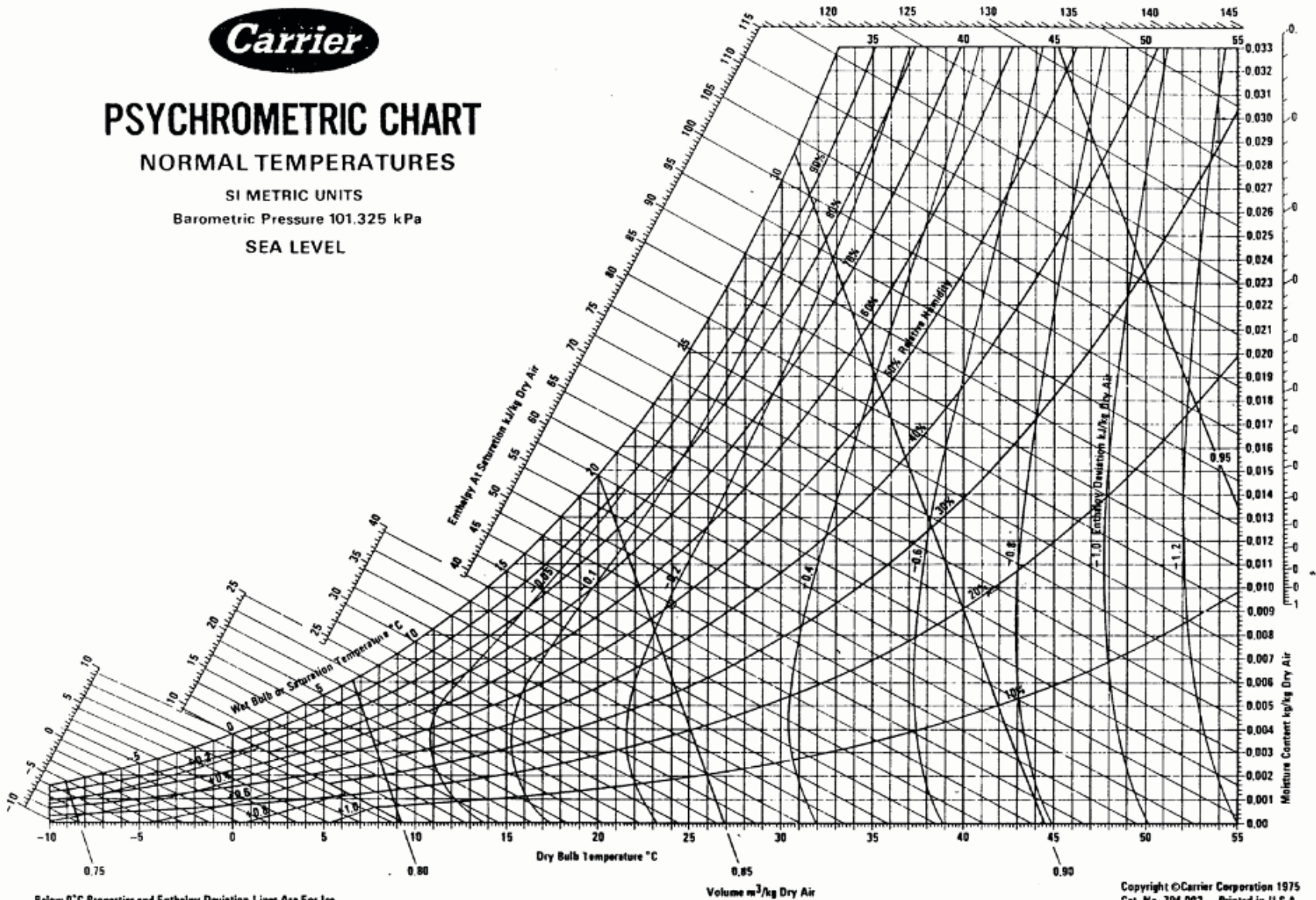

Below 0°C Properties and Enthalpy Deviation Lines Are For Ice

Copyright ©Carrier Corporation 1975
Cat. No. 794 002 Printed in U.S.A.

Sorption Isotherms

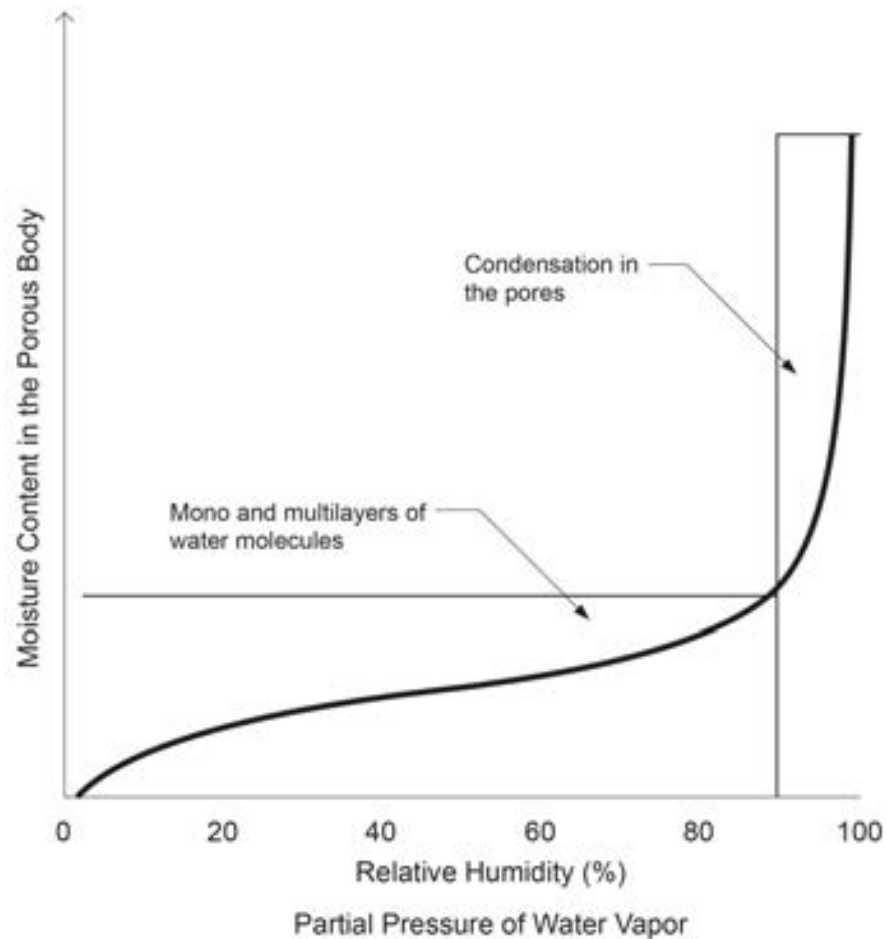

Change in the storage of moisture in a porous building material as the partial pressure of water vapor in the ambient air increases from zero to full saturation value at a given temperature.

Sorption Curve

From M.K. Kumaran, ASTM MNL 18-2nd Edition,
Moisture Control in Buildings, 2009

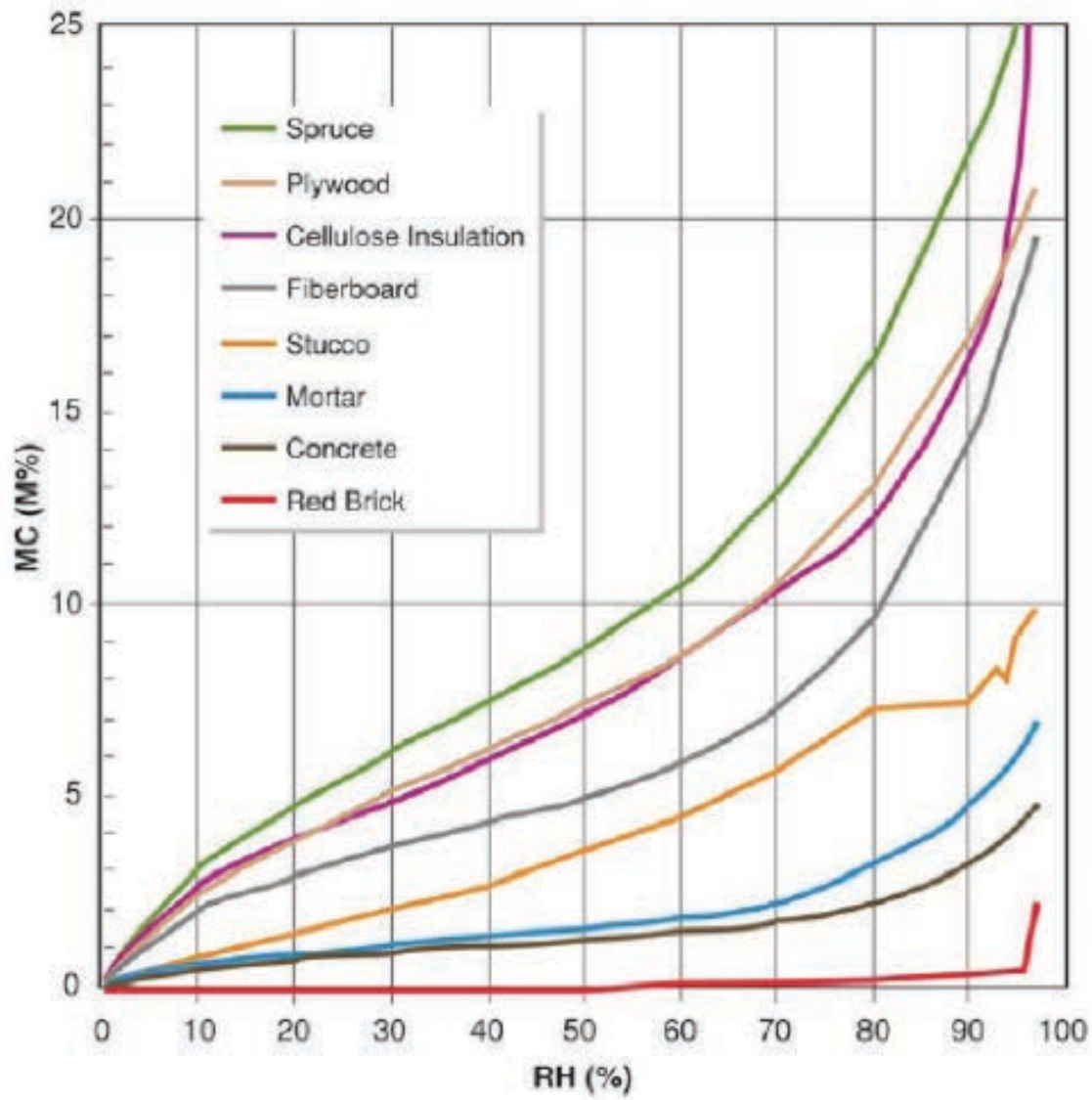

Moisture Content vs. Relative Humidity

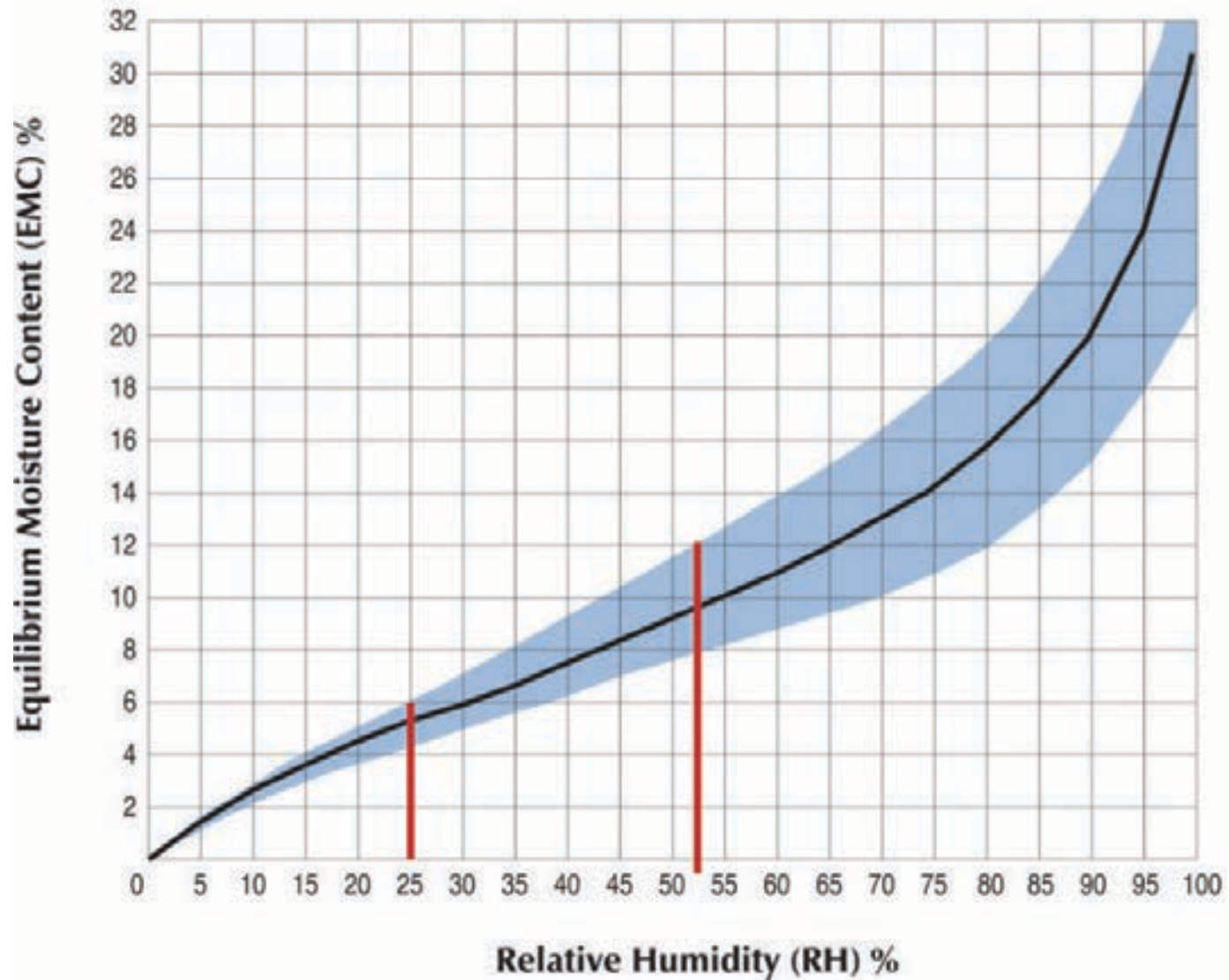

2nd Law of Thermodynamics

Heat Flow Is From Warm To Cold

Moisture Flow Is From Warm To Cold

Moisture Flow Is From More To Less

Air Flow Is From A Higher Pressure to a
Lower Pressure

Gravity Acts Down



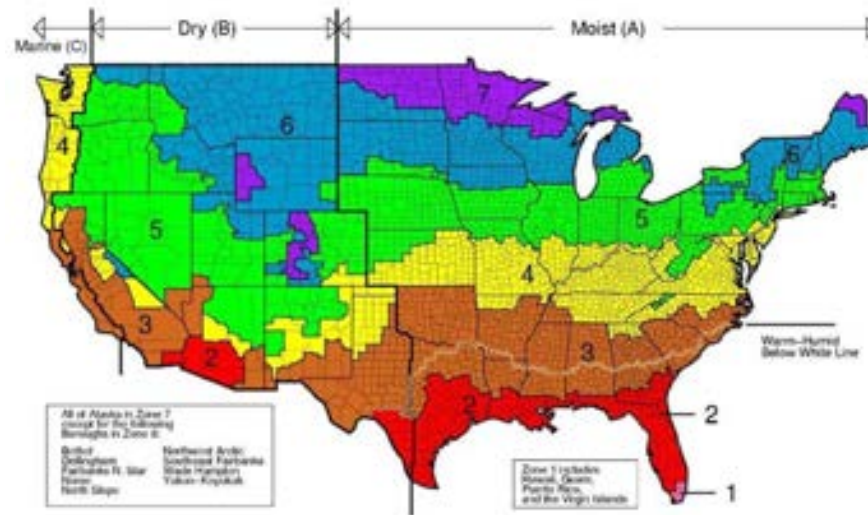

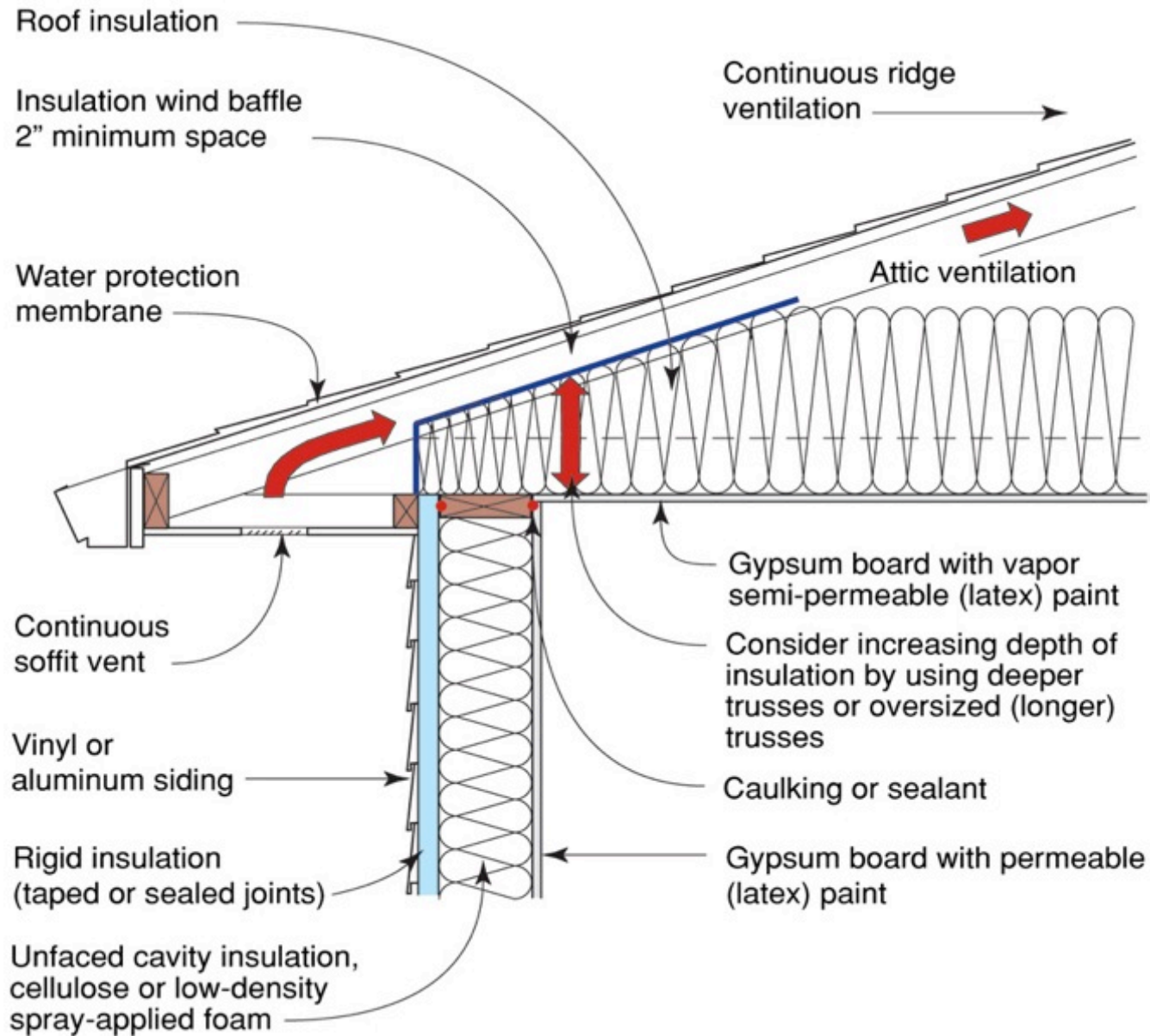

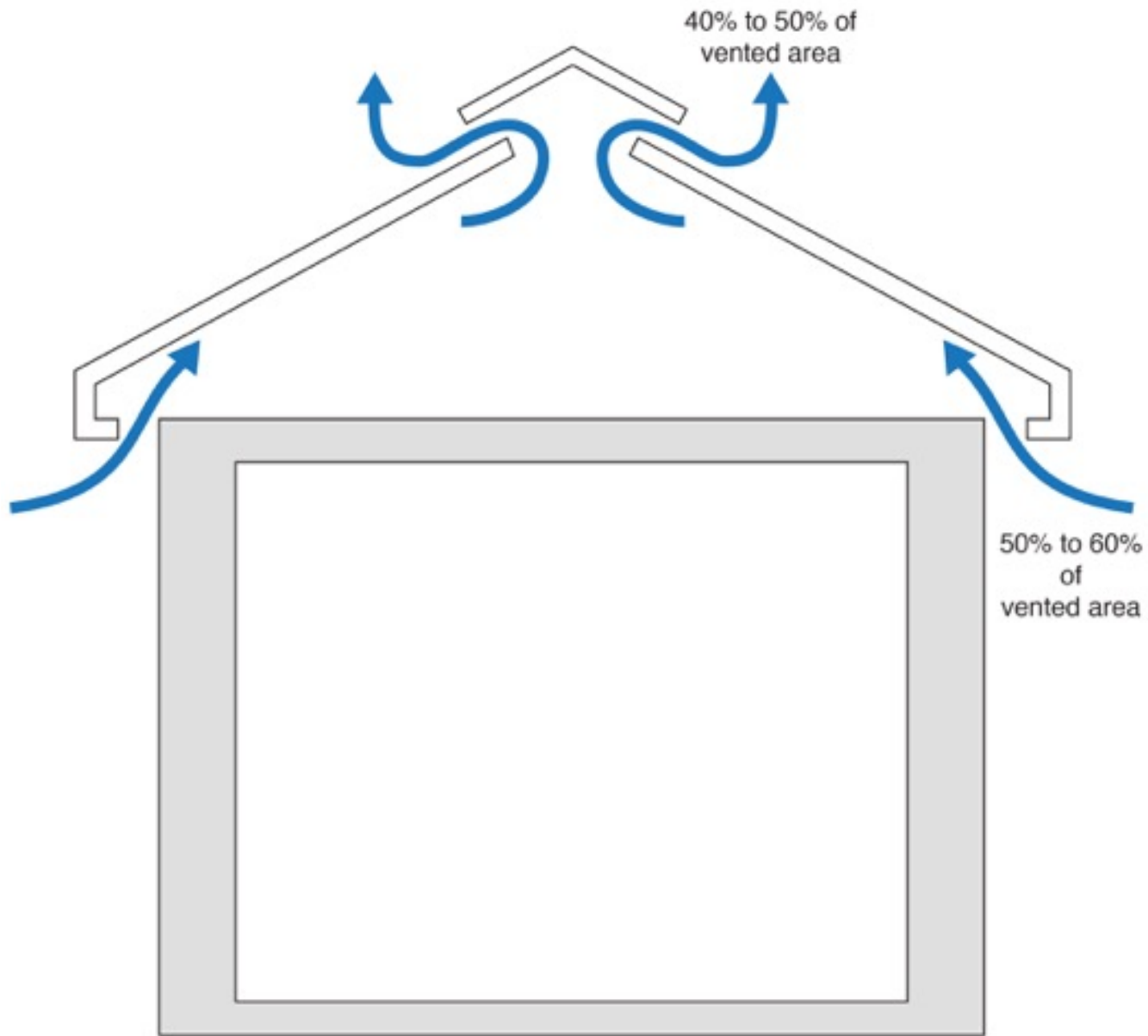

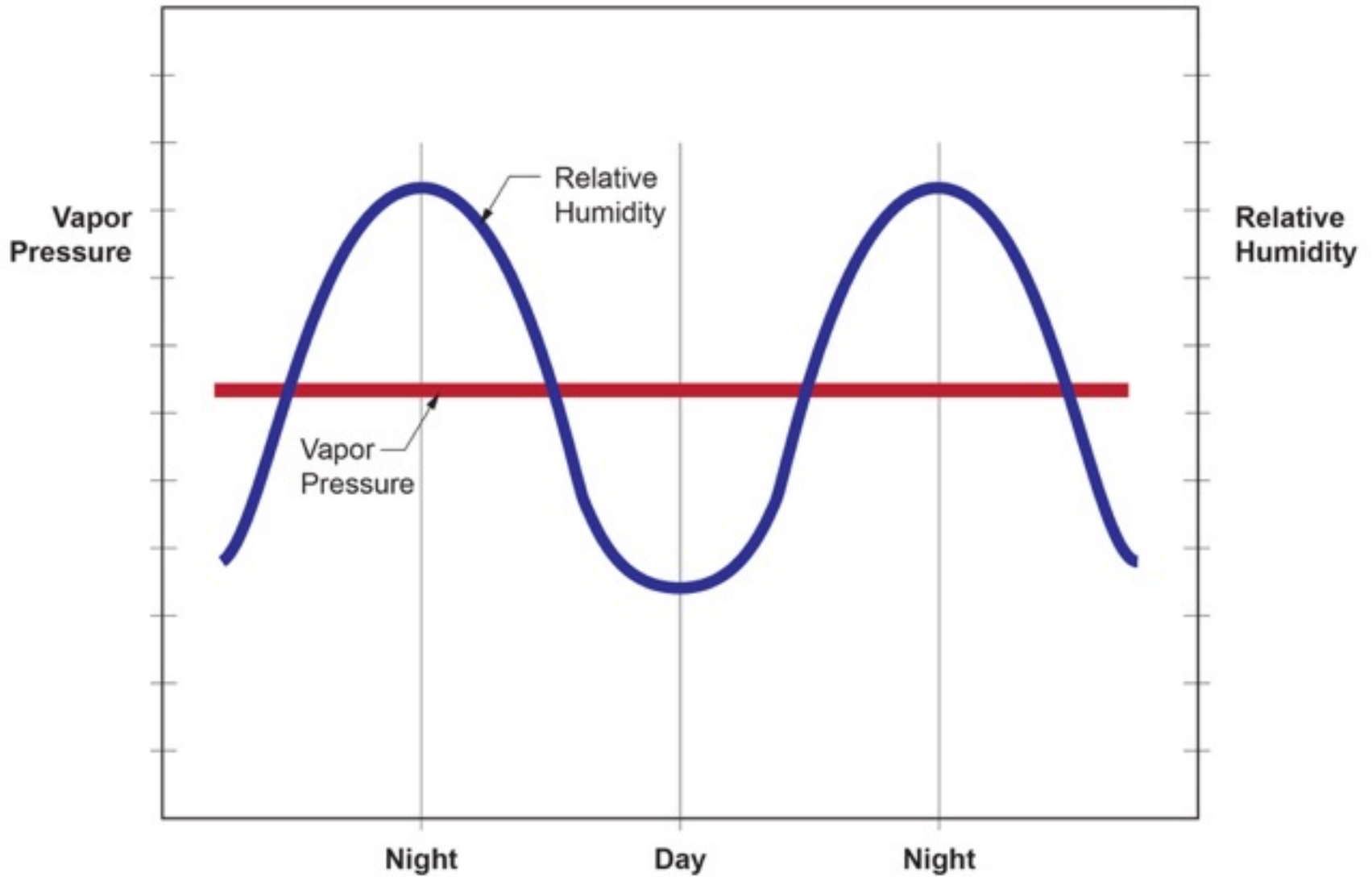



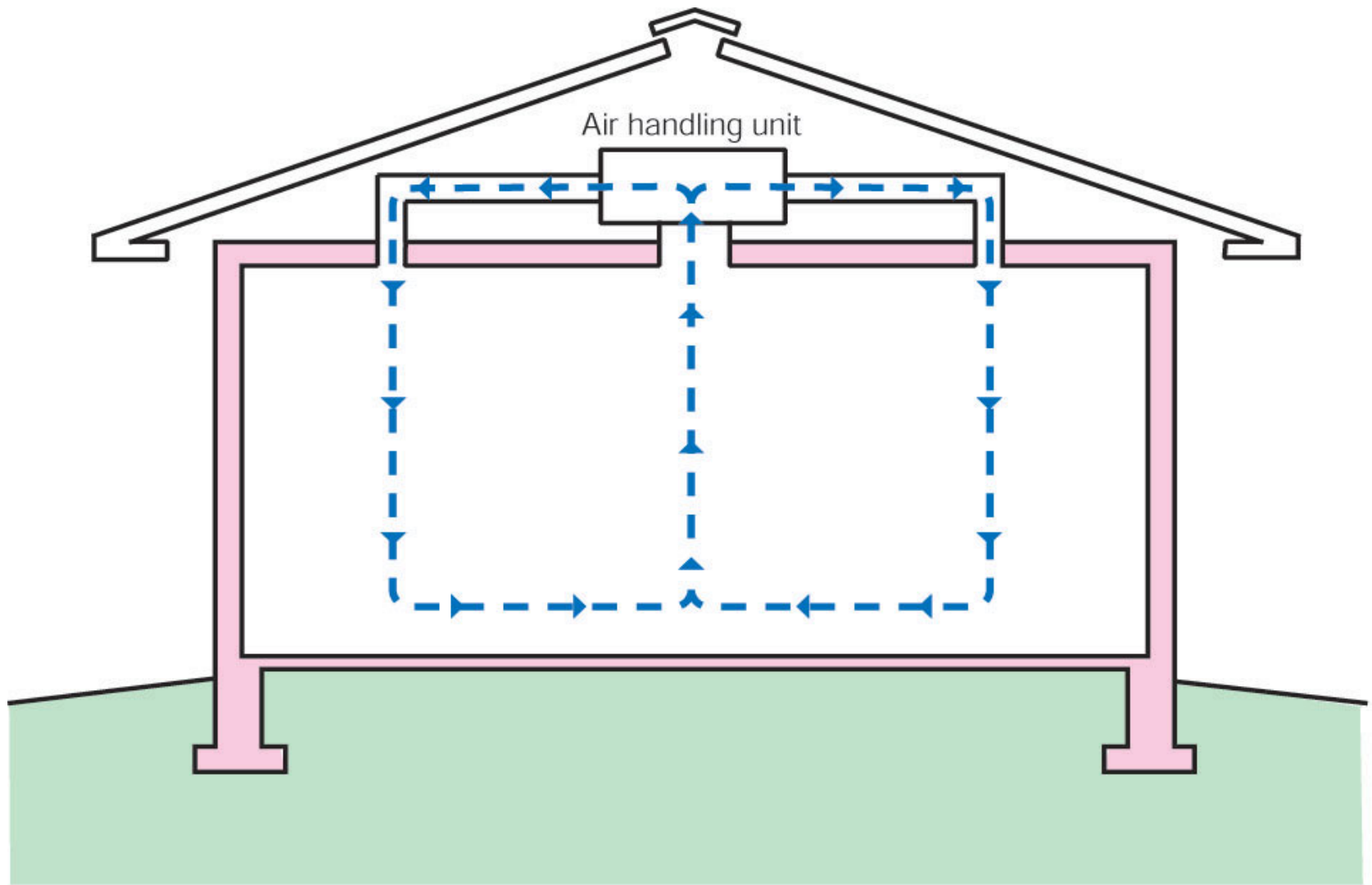

Note: Colored shading depicts the building's thermal barrier and pressure boundary. The thermal barrier and pressure boundary enclose the conditioned space.

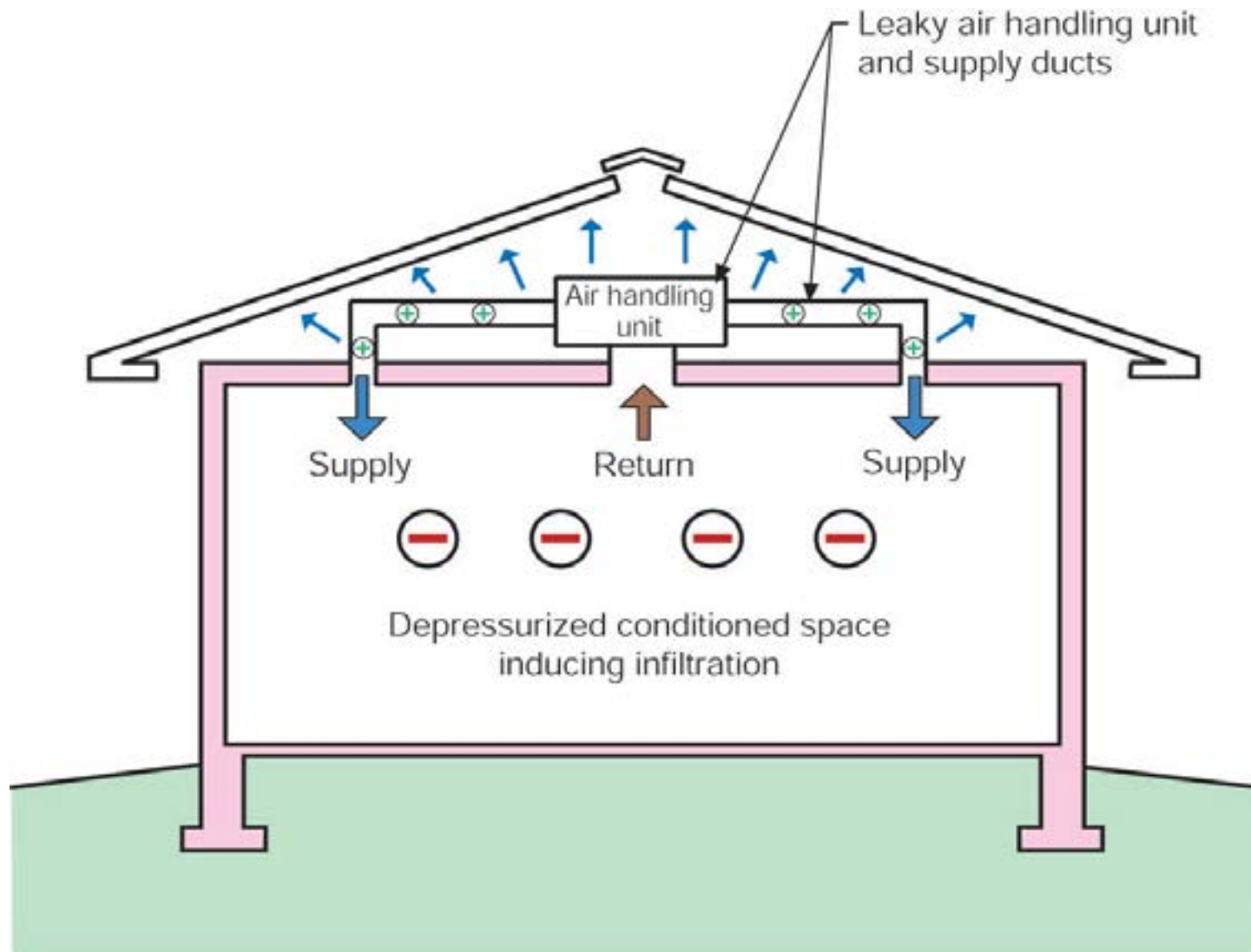

Note: Colored shading depicts the building's thermal barrier and pressure boundary. The thermal barrier and pressure boundary enclose the conditioned space.

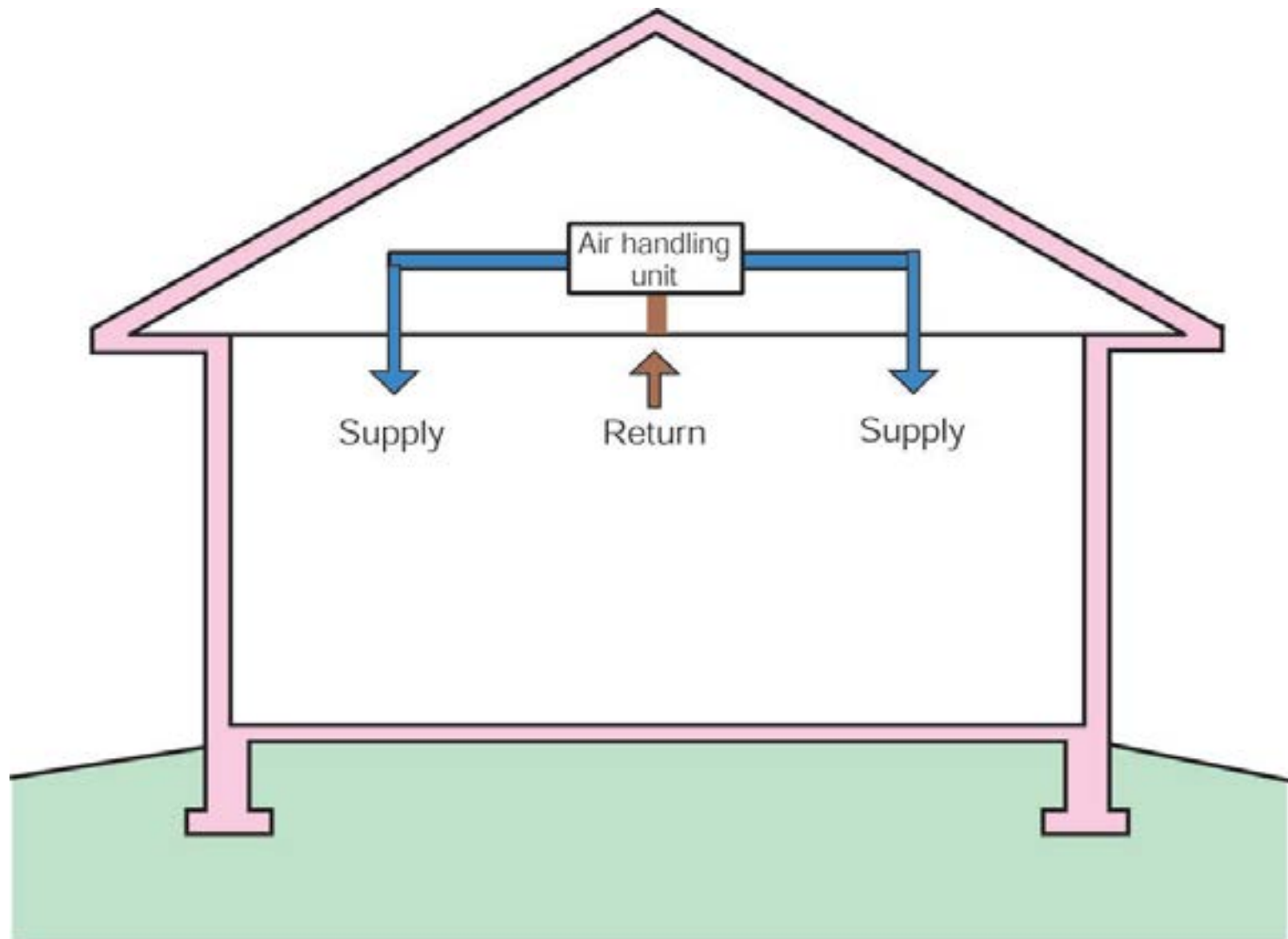

Note: Colored shading depicts the building's thermal barrier and pressure boundary. The thermal barrier and pressure boundary enclose the conditioned space.

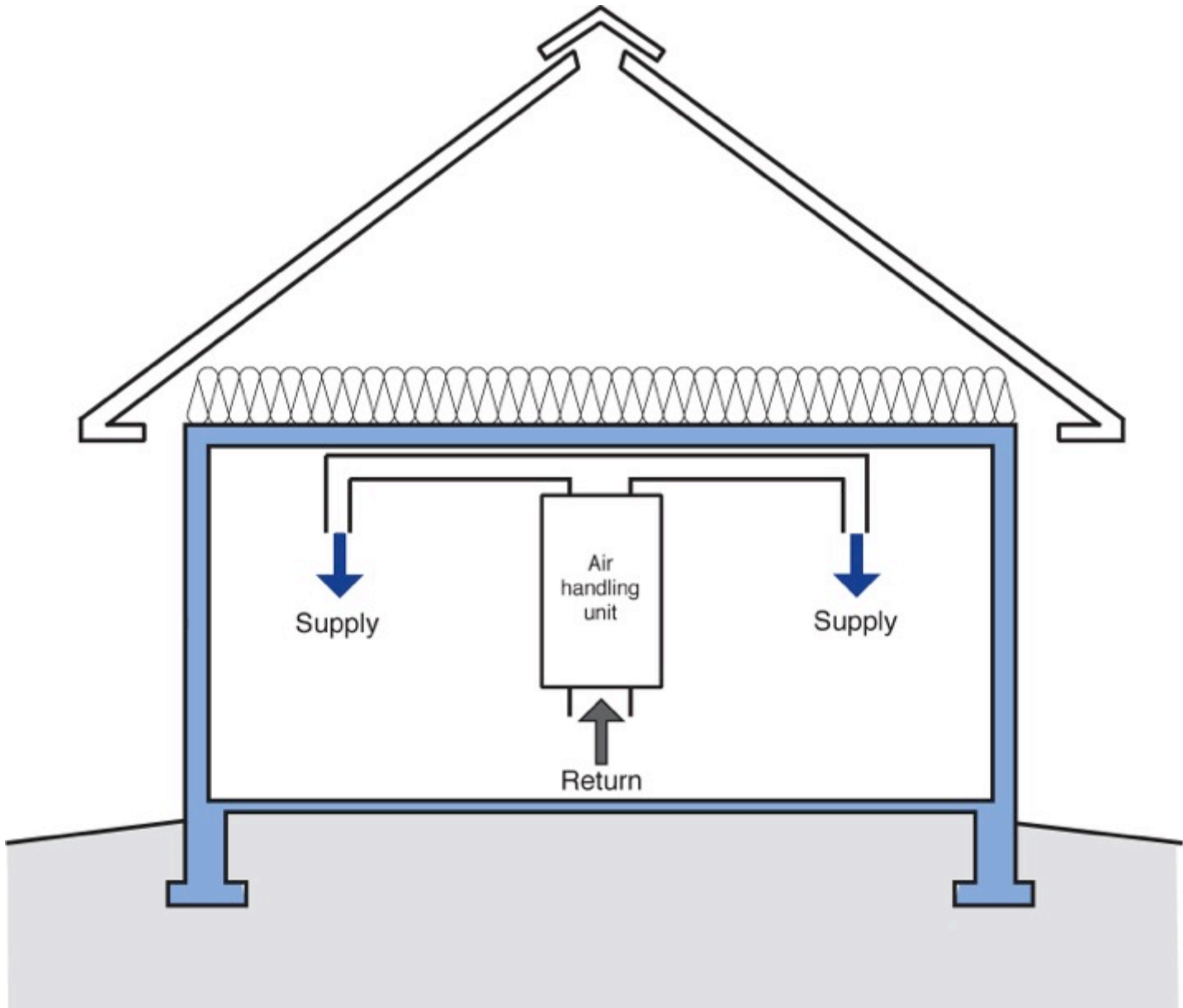

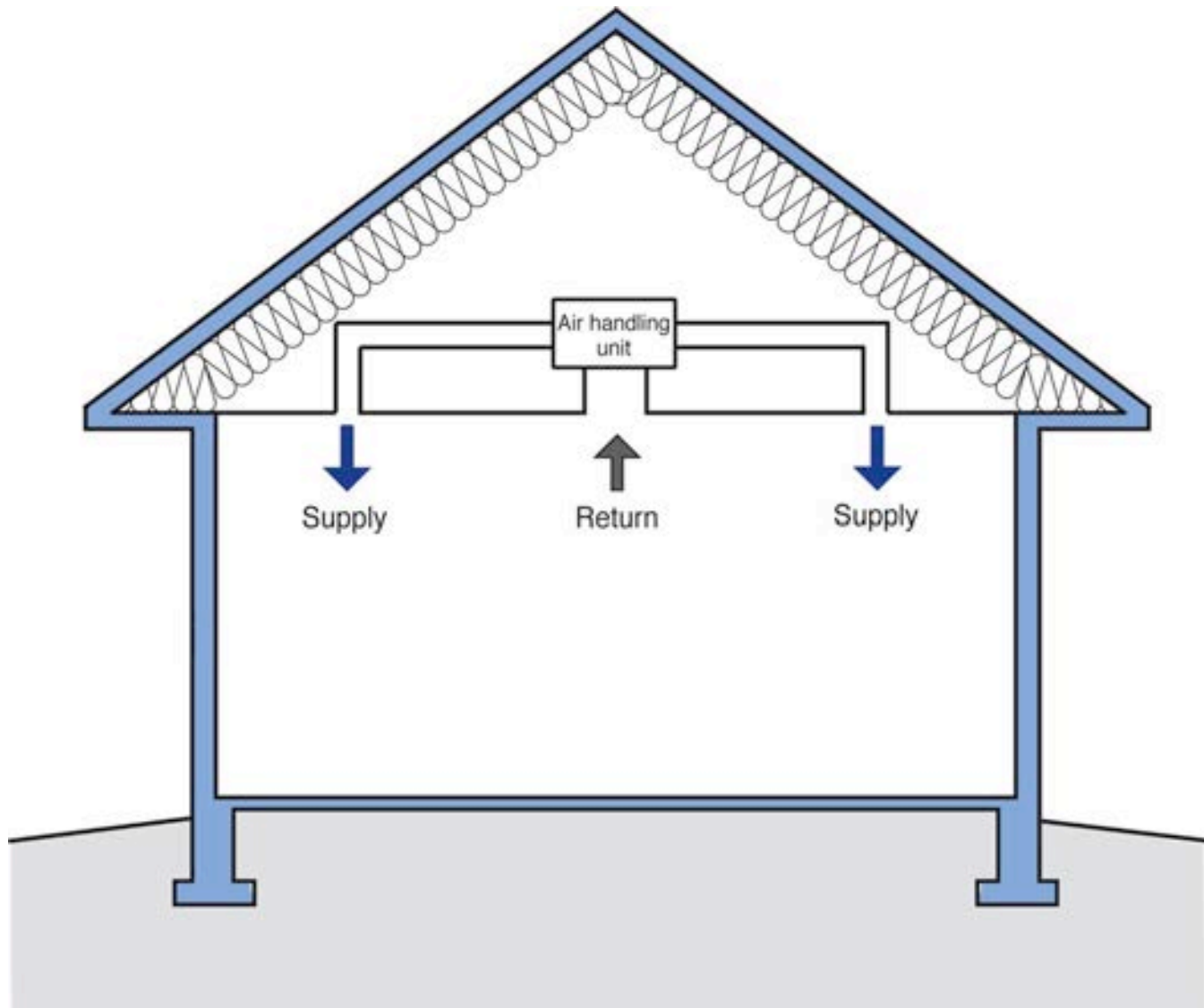

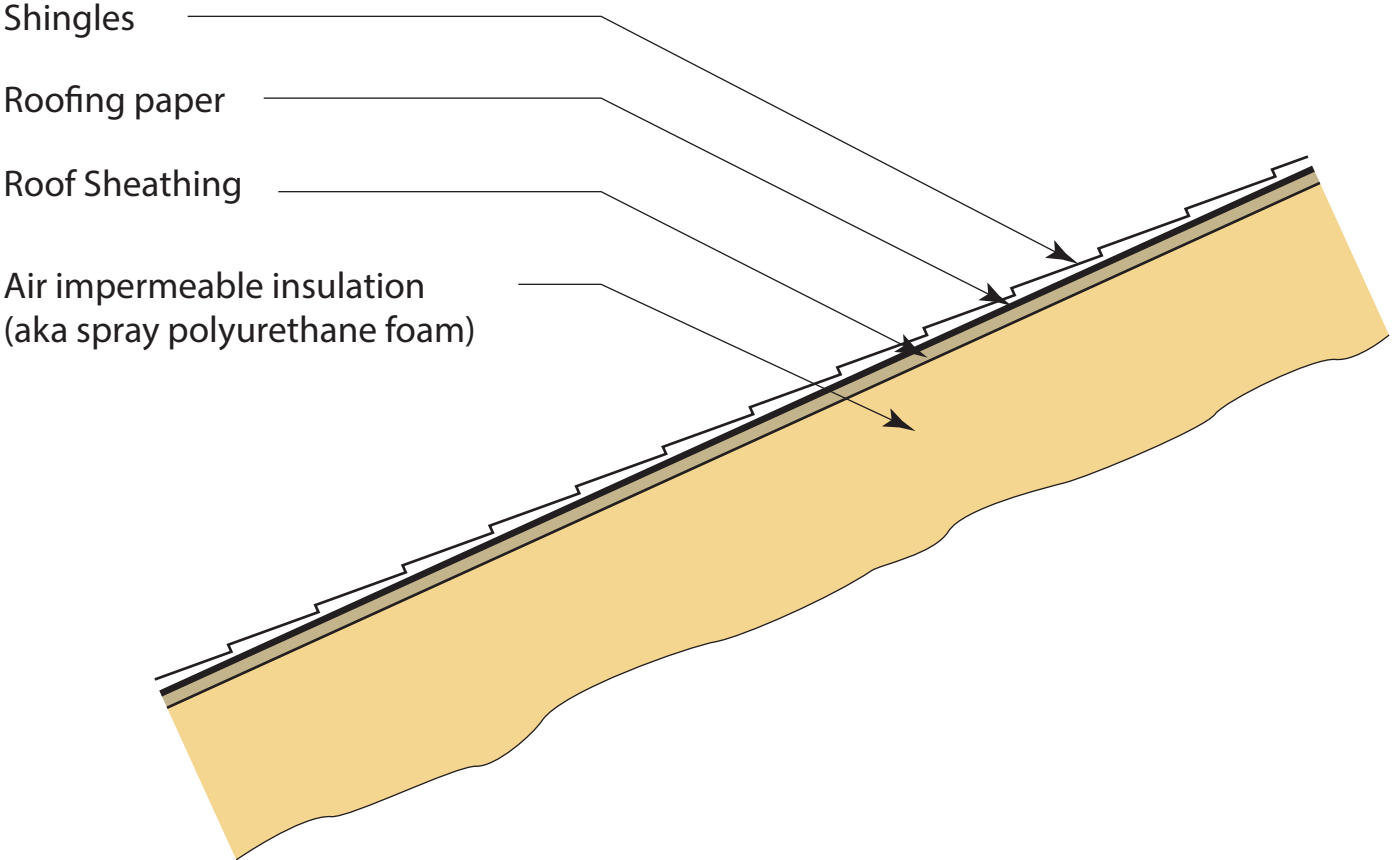

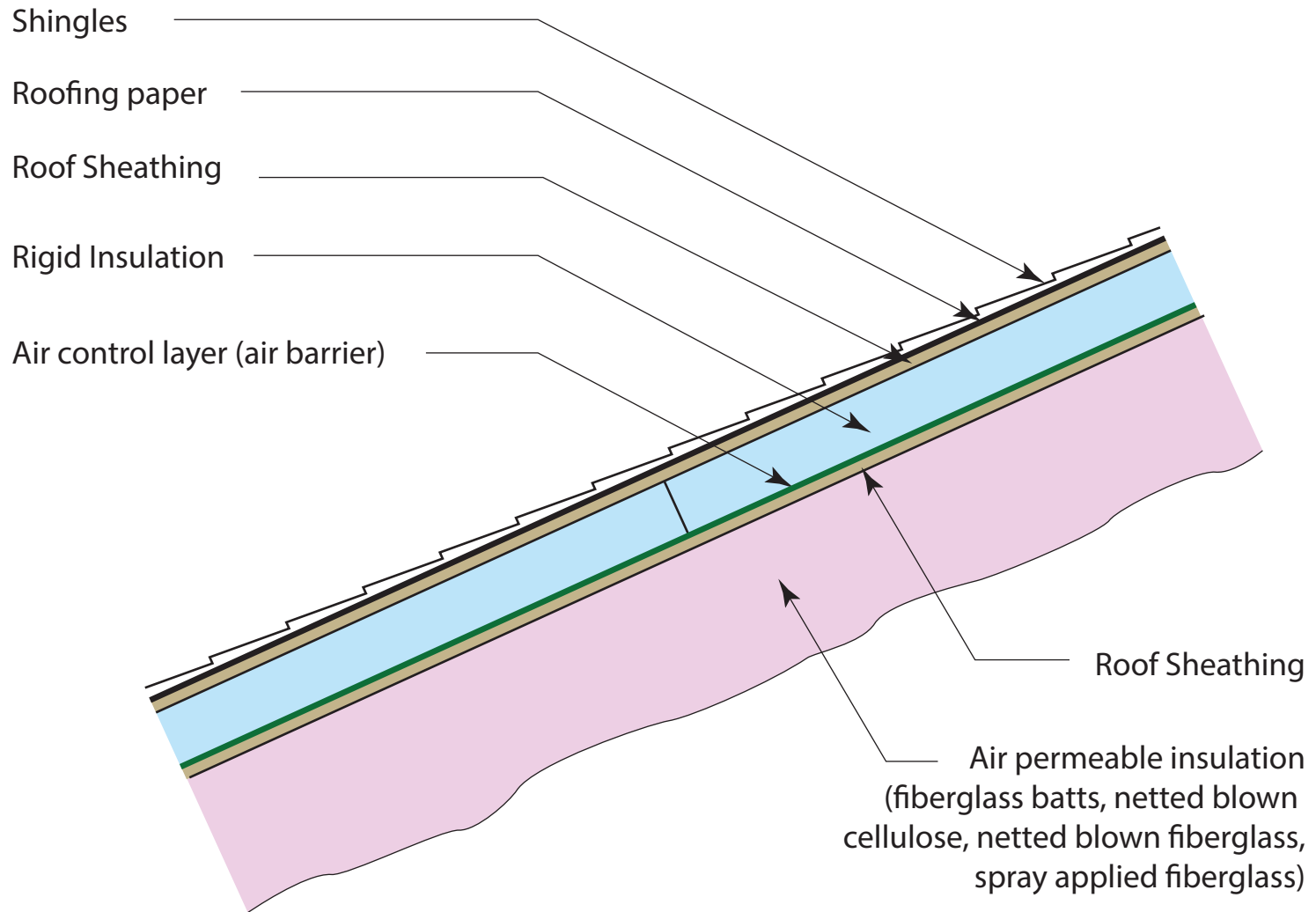

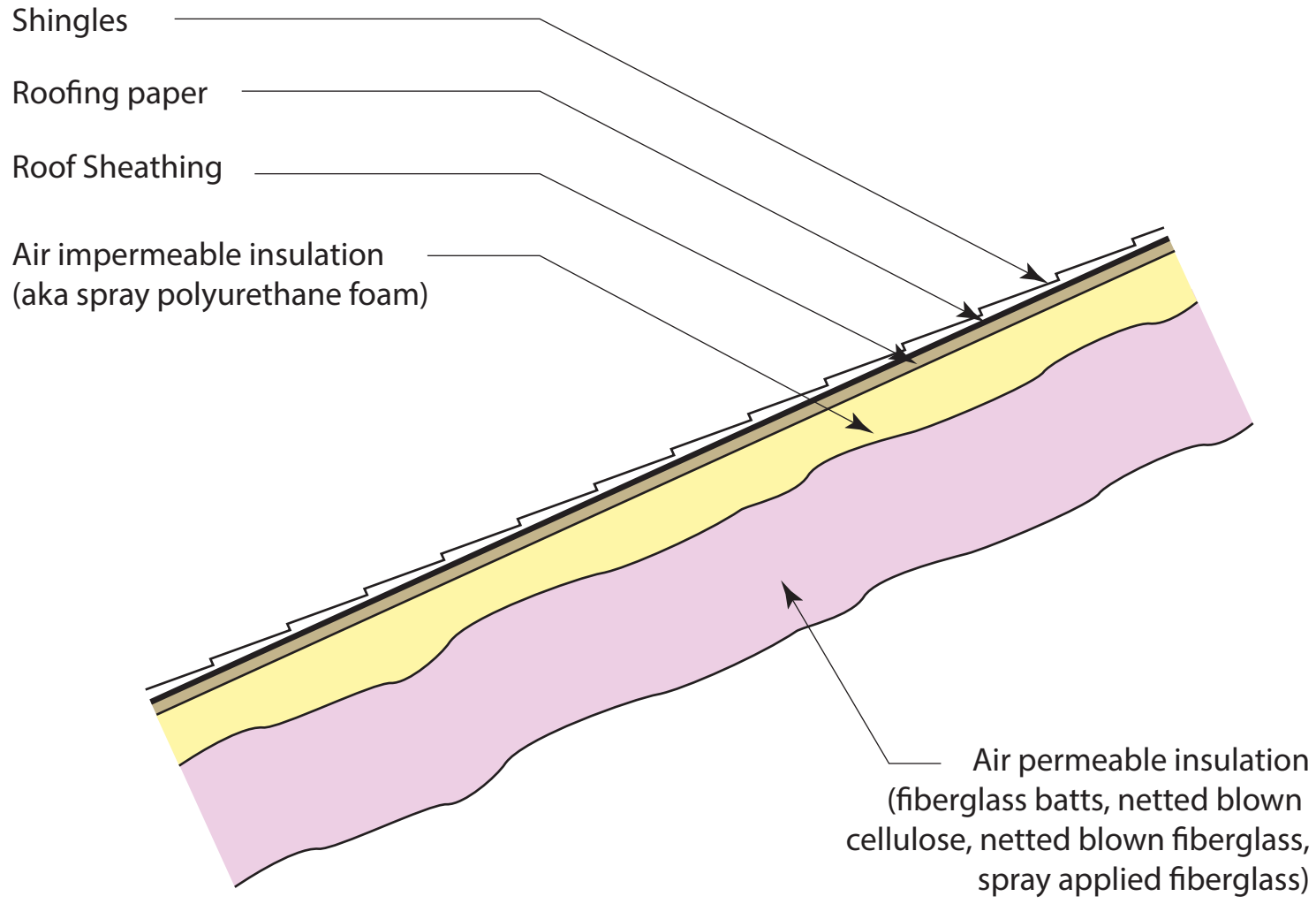

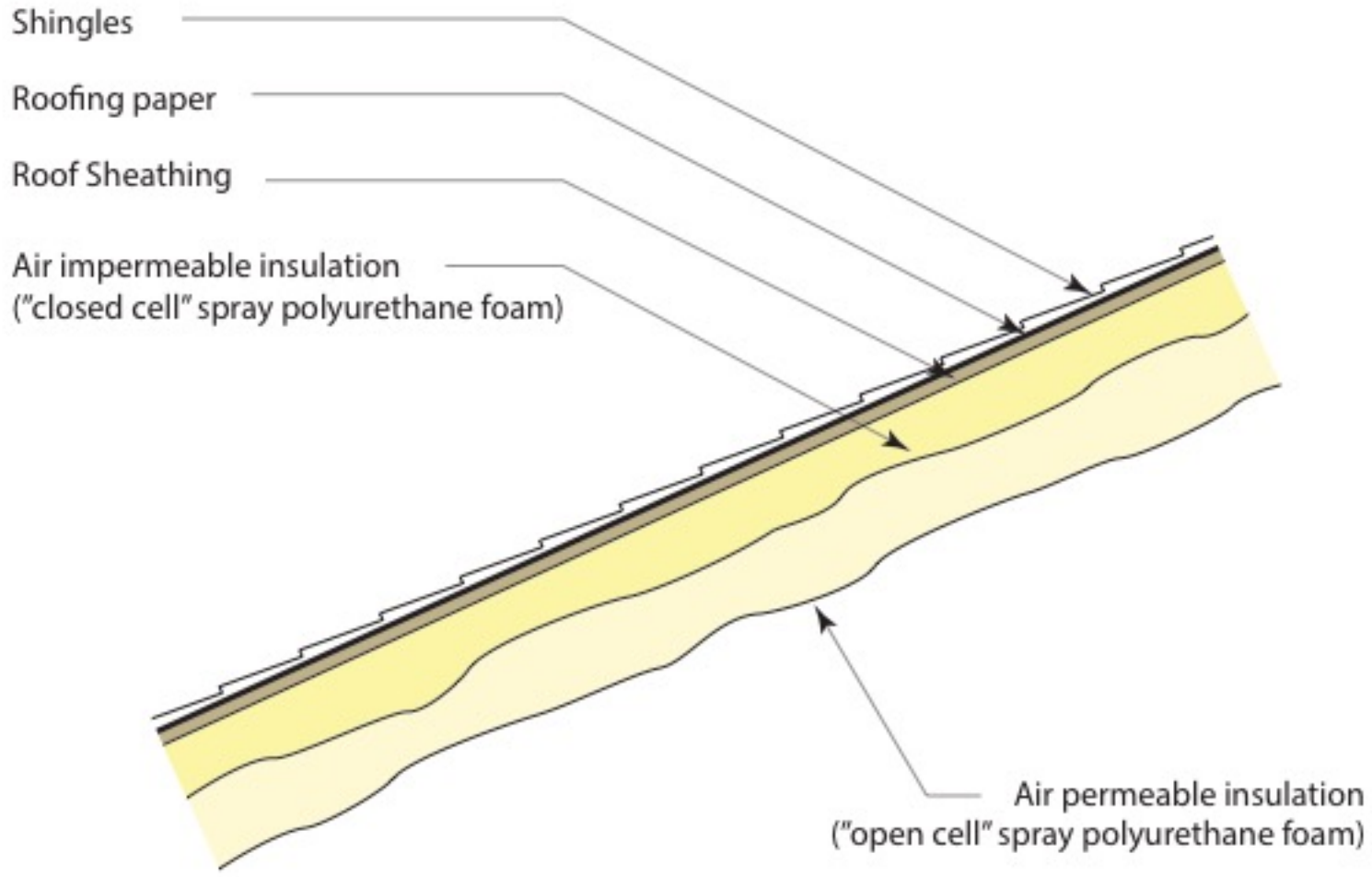





Sweating Ducts

Sweating Ducts

Light Colored Roofs

Cool Roofs

Radiant Barriers

ACCA Manual J, S and D

ASHRAE 62.2

Ductwork Attic Dehumidification System

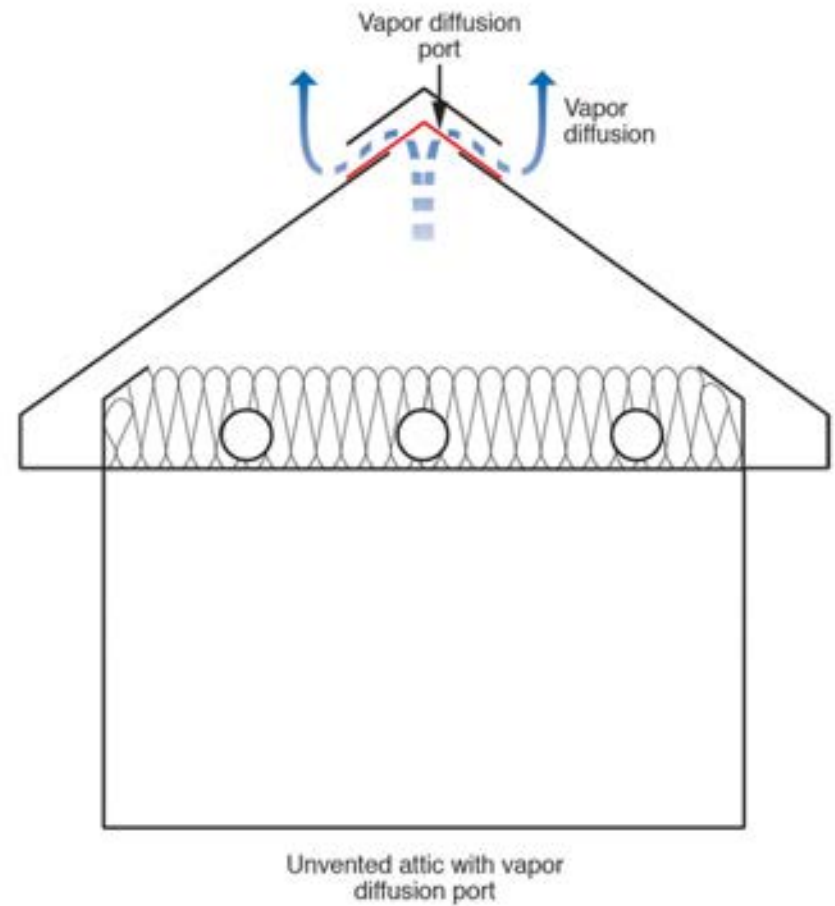
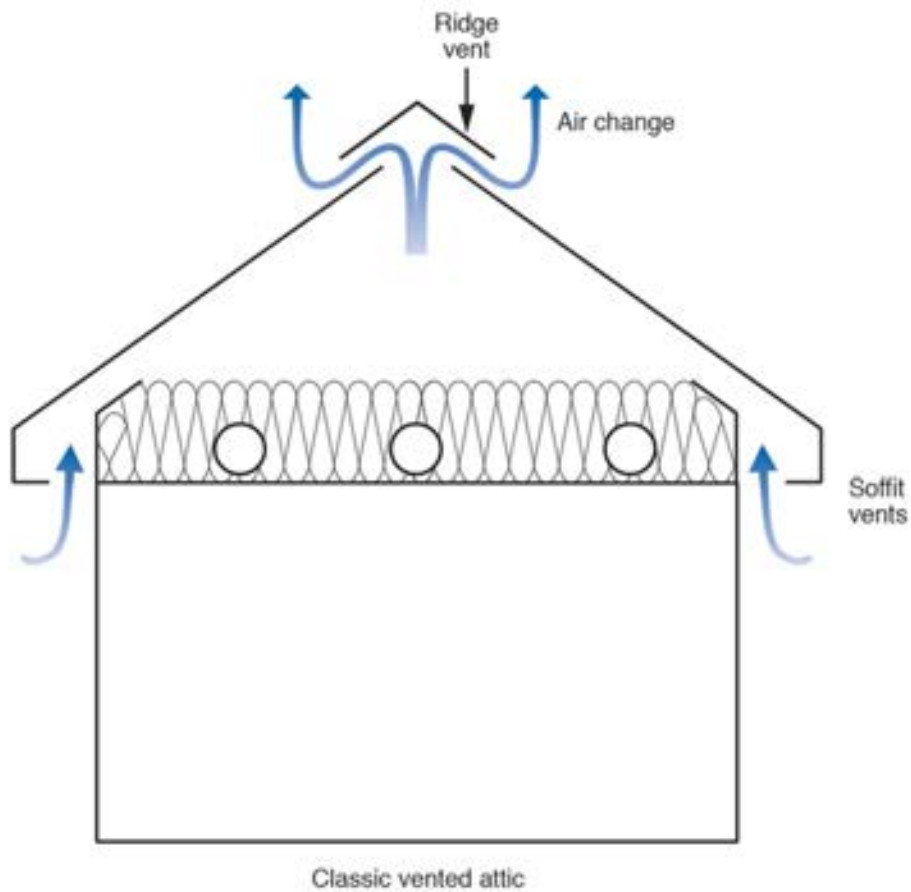

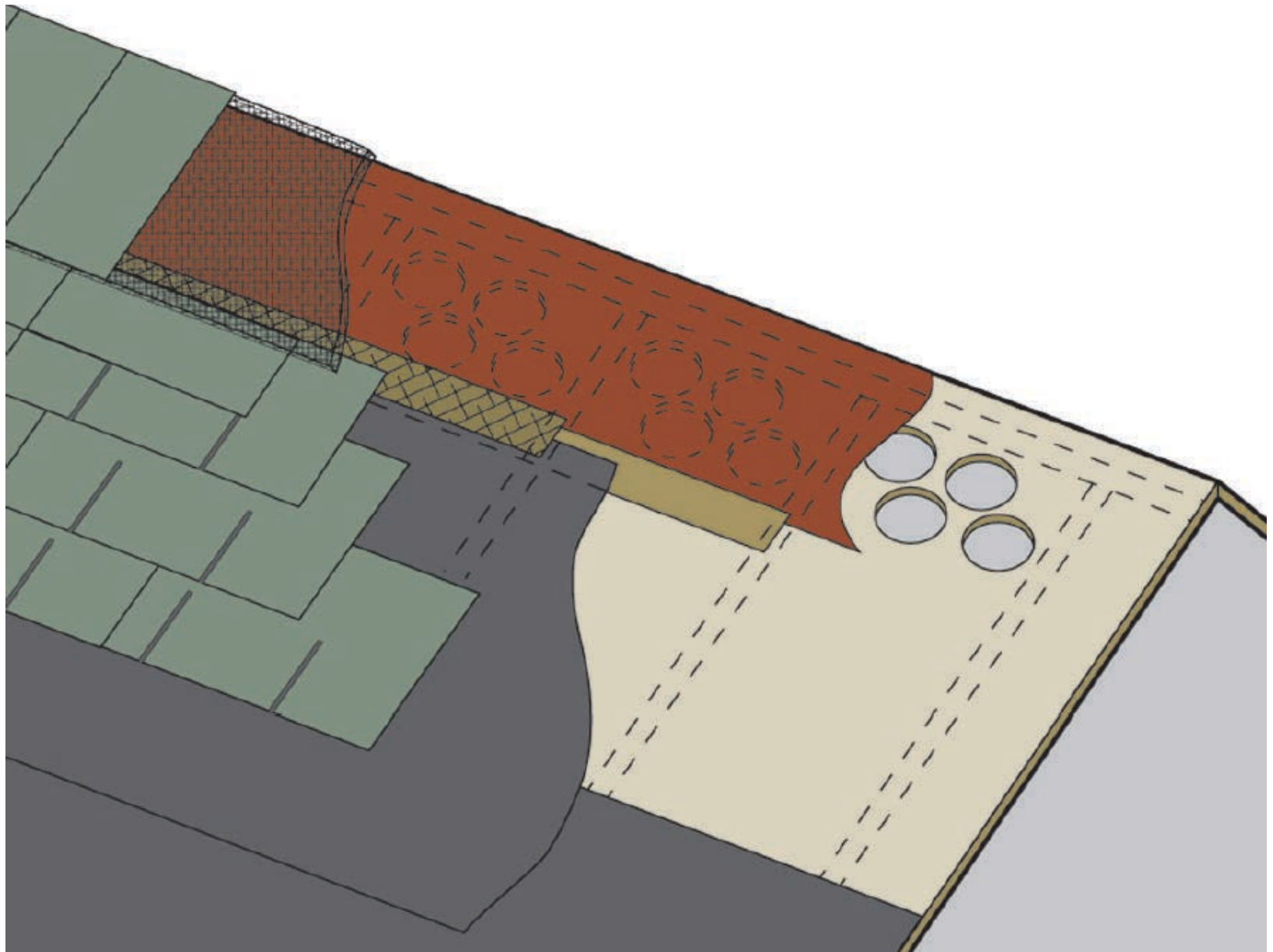

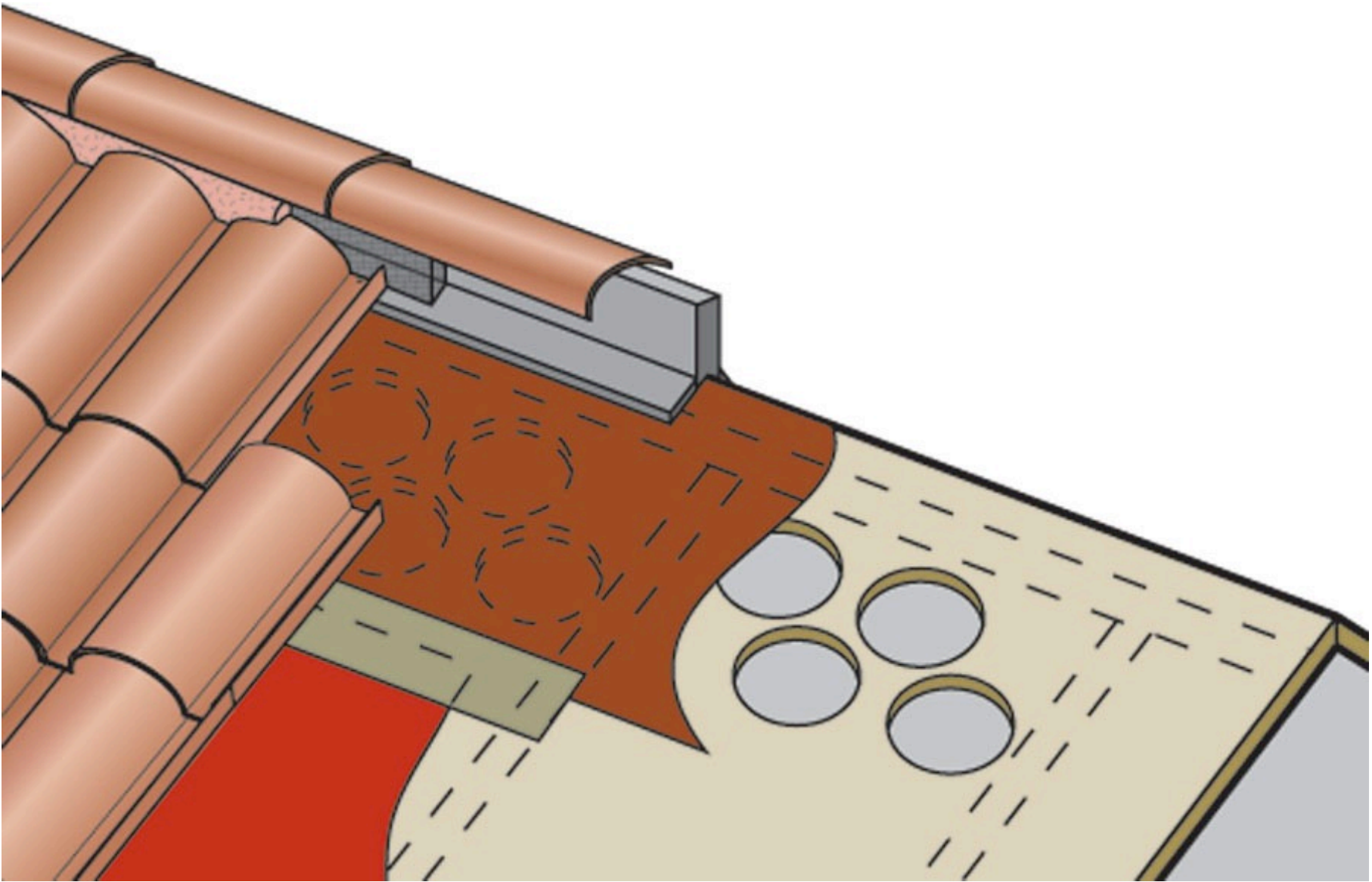

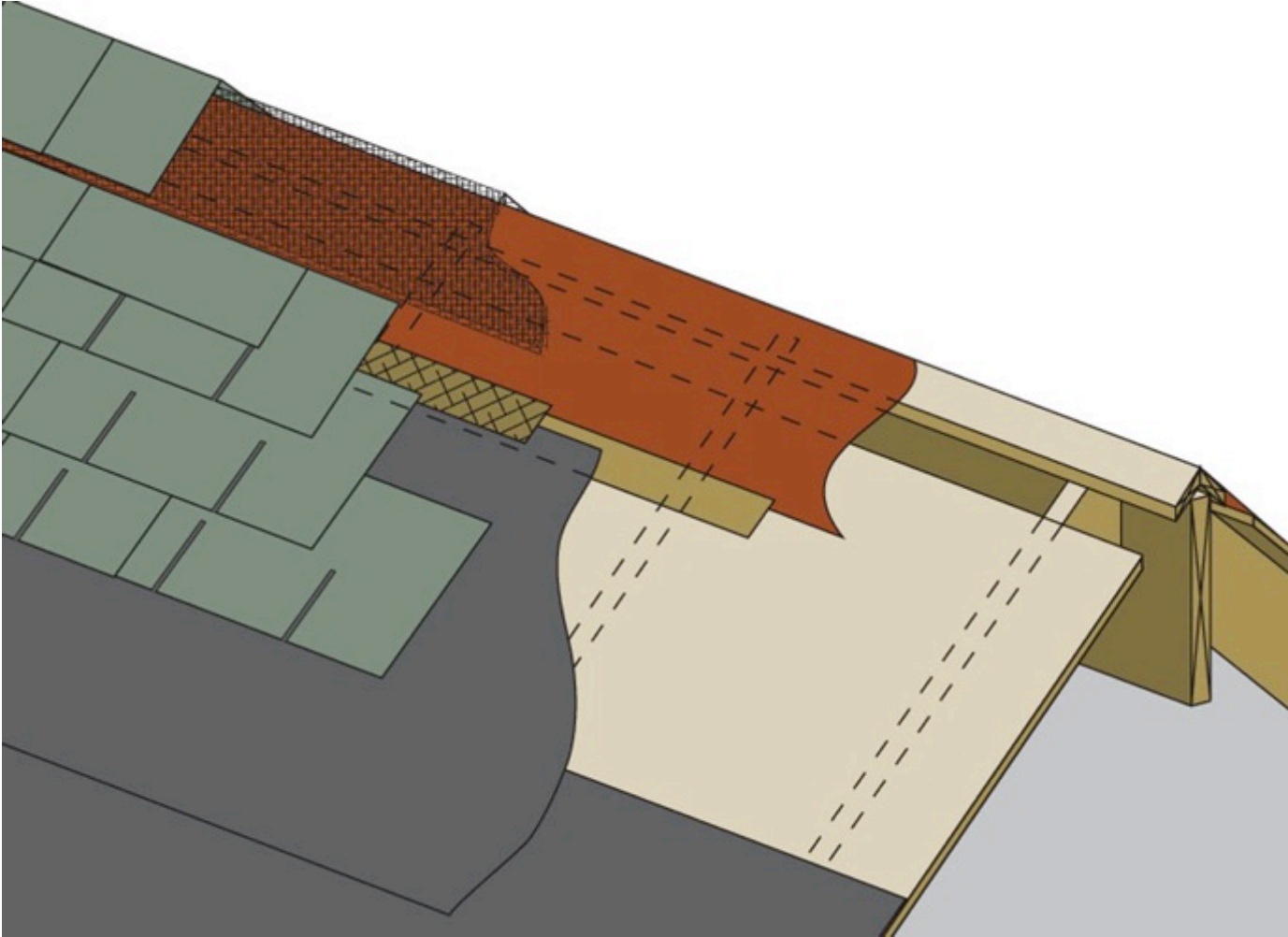

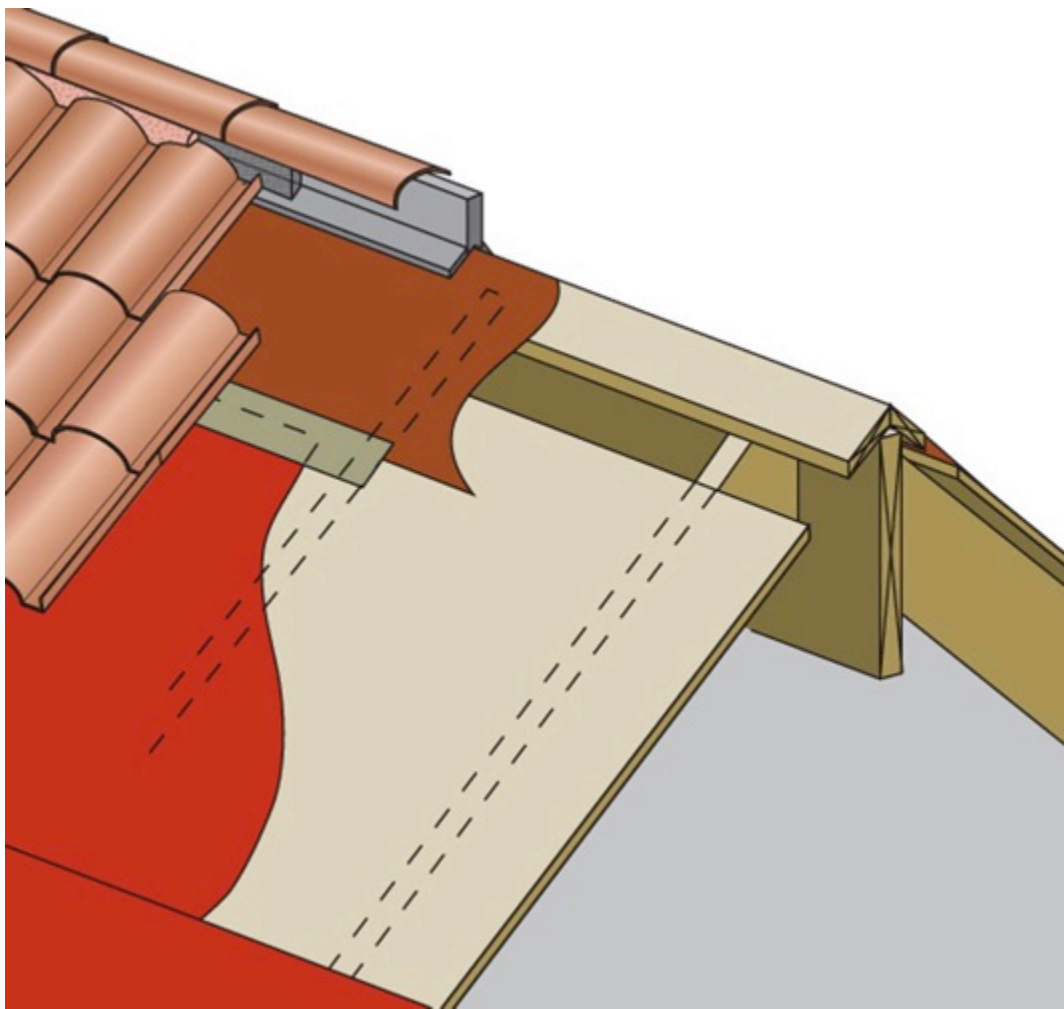













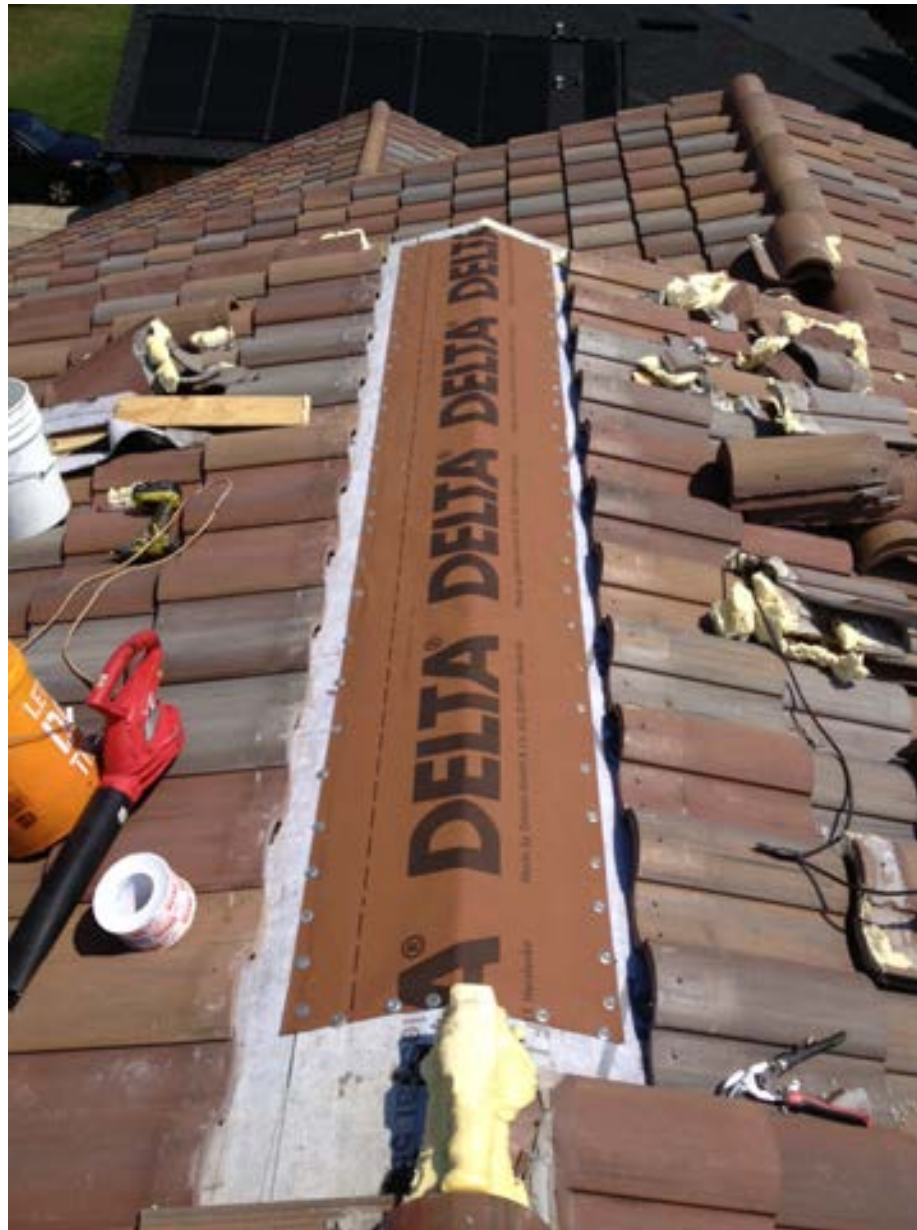



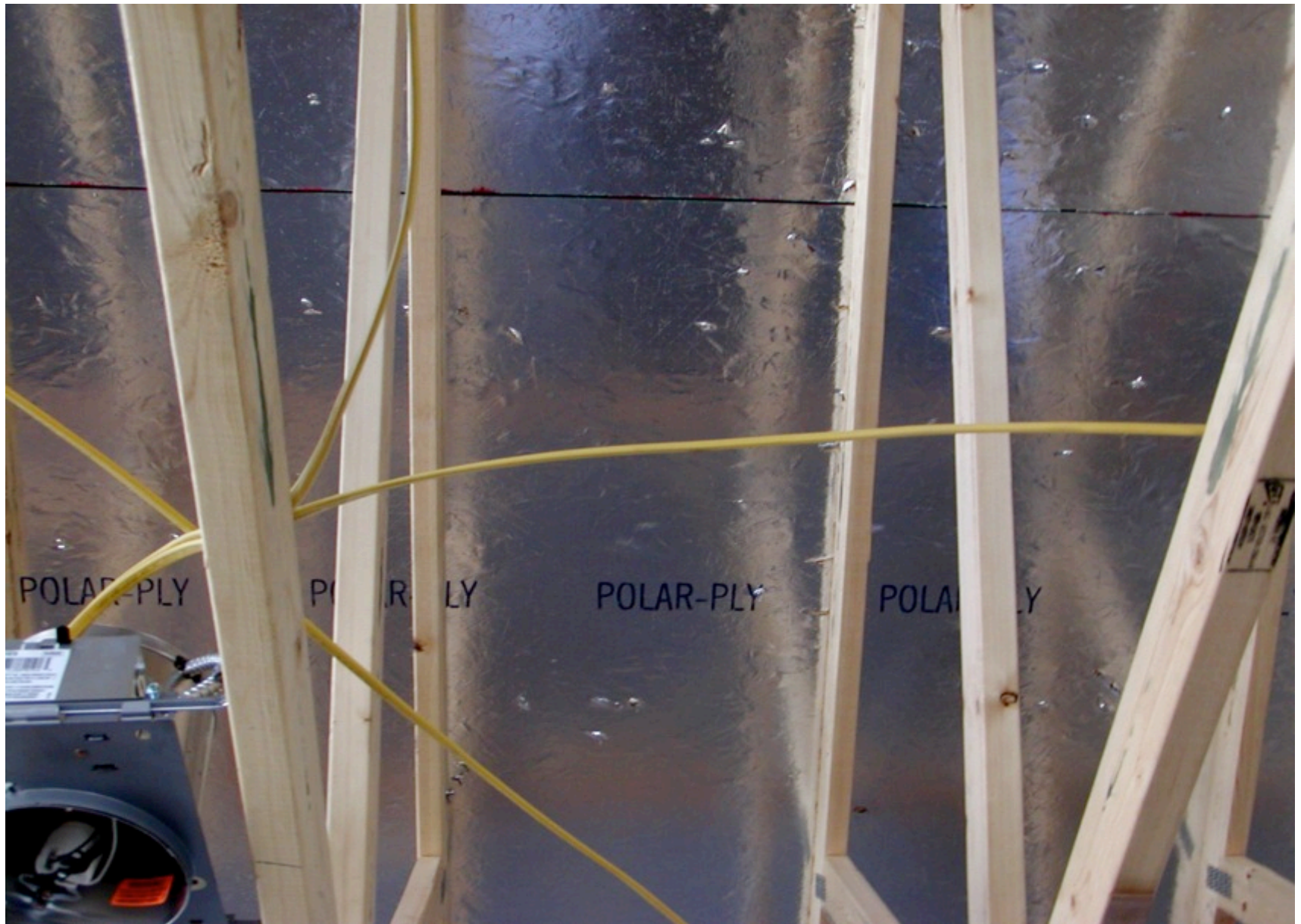









































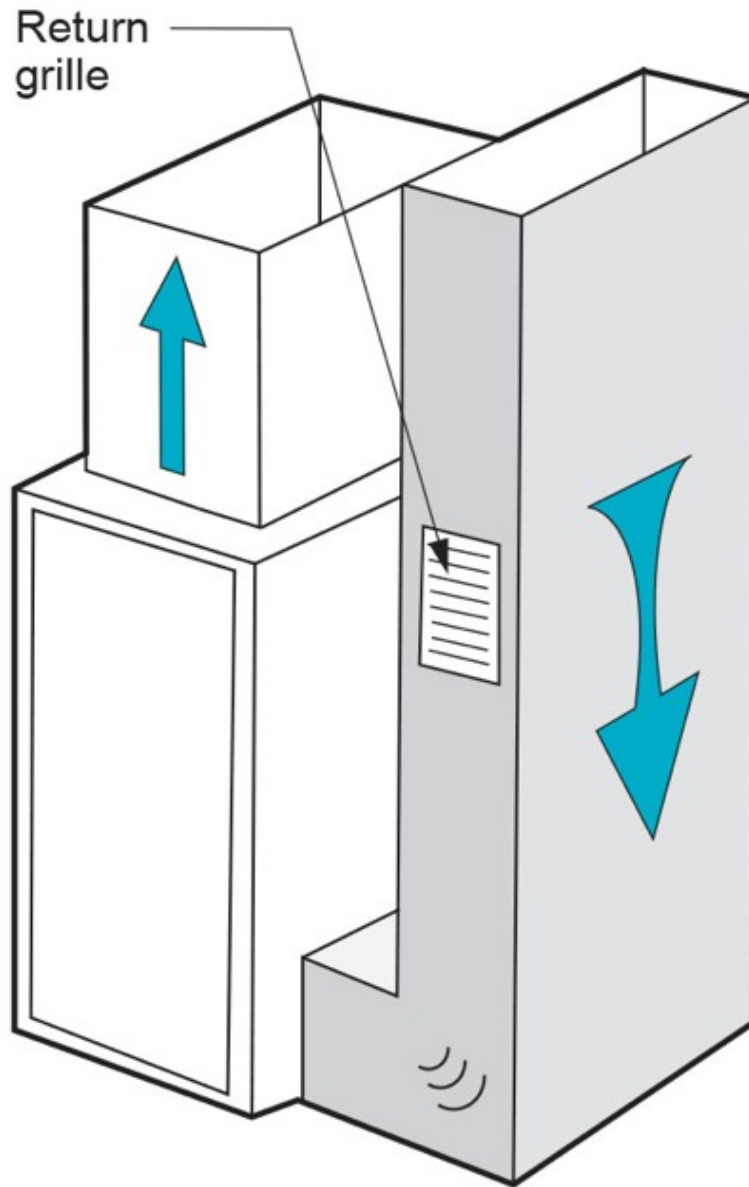

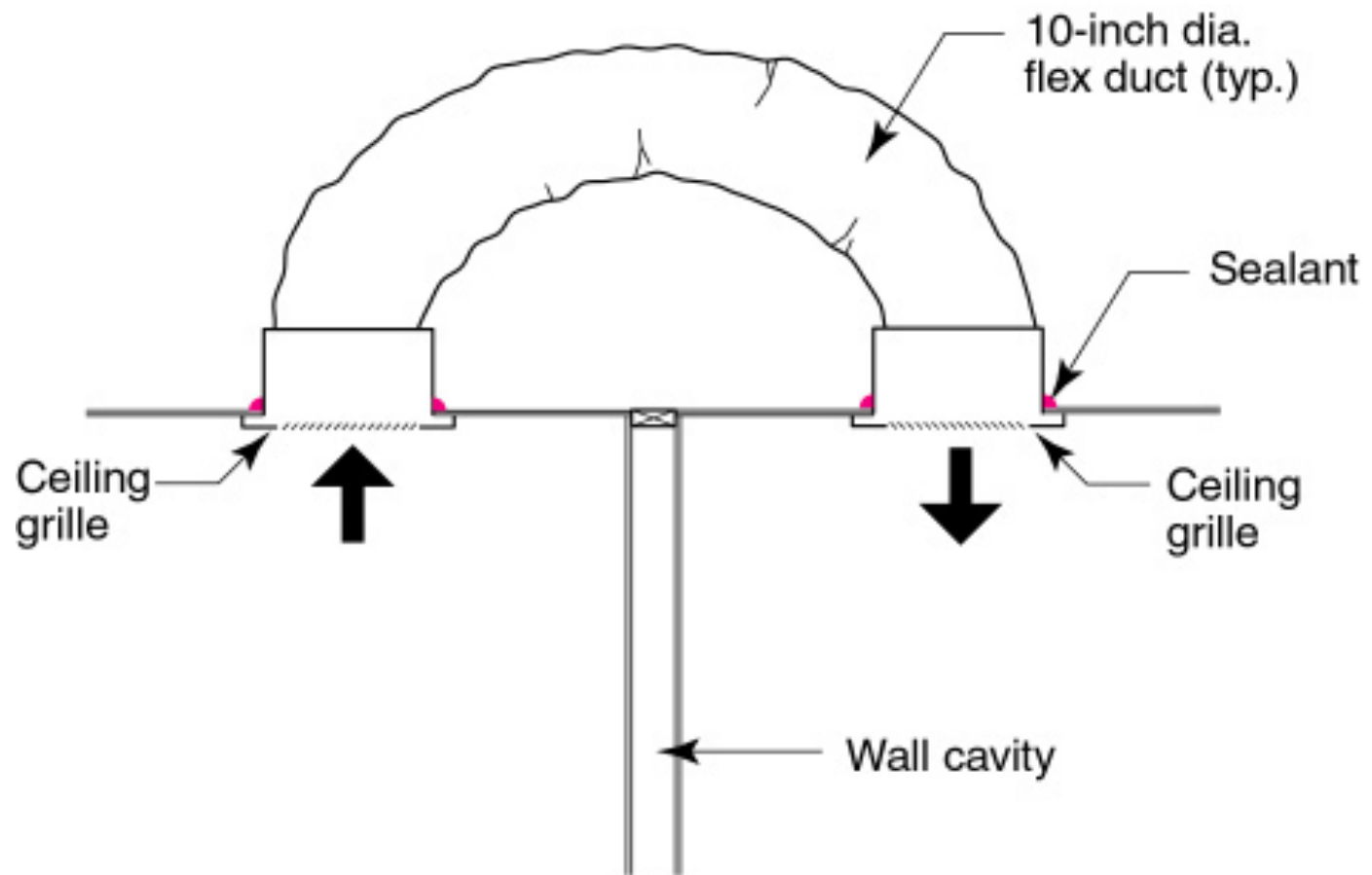

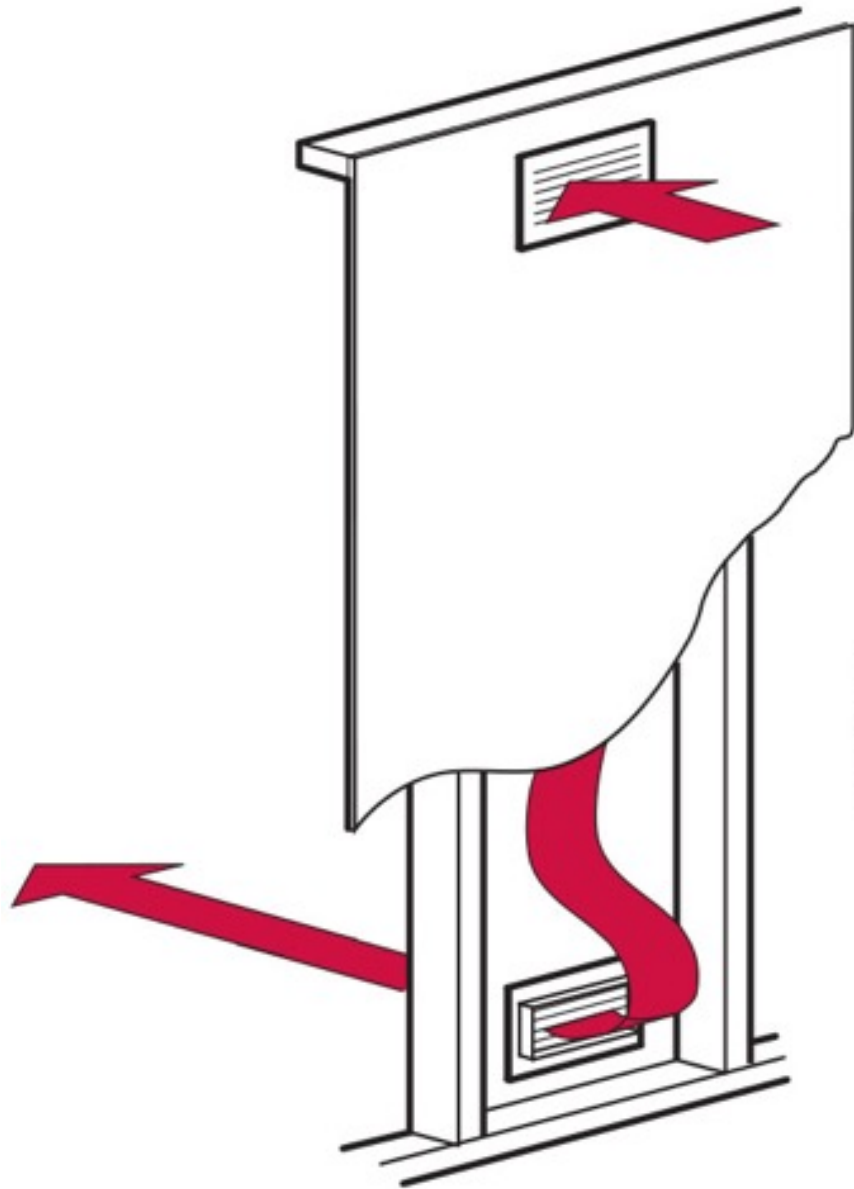

Cavity is sealed tight,
drywall glued to studs and
plates on both sides





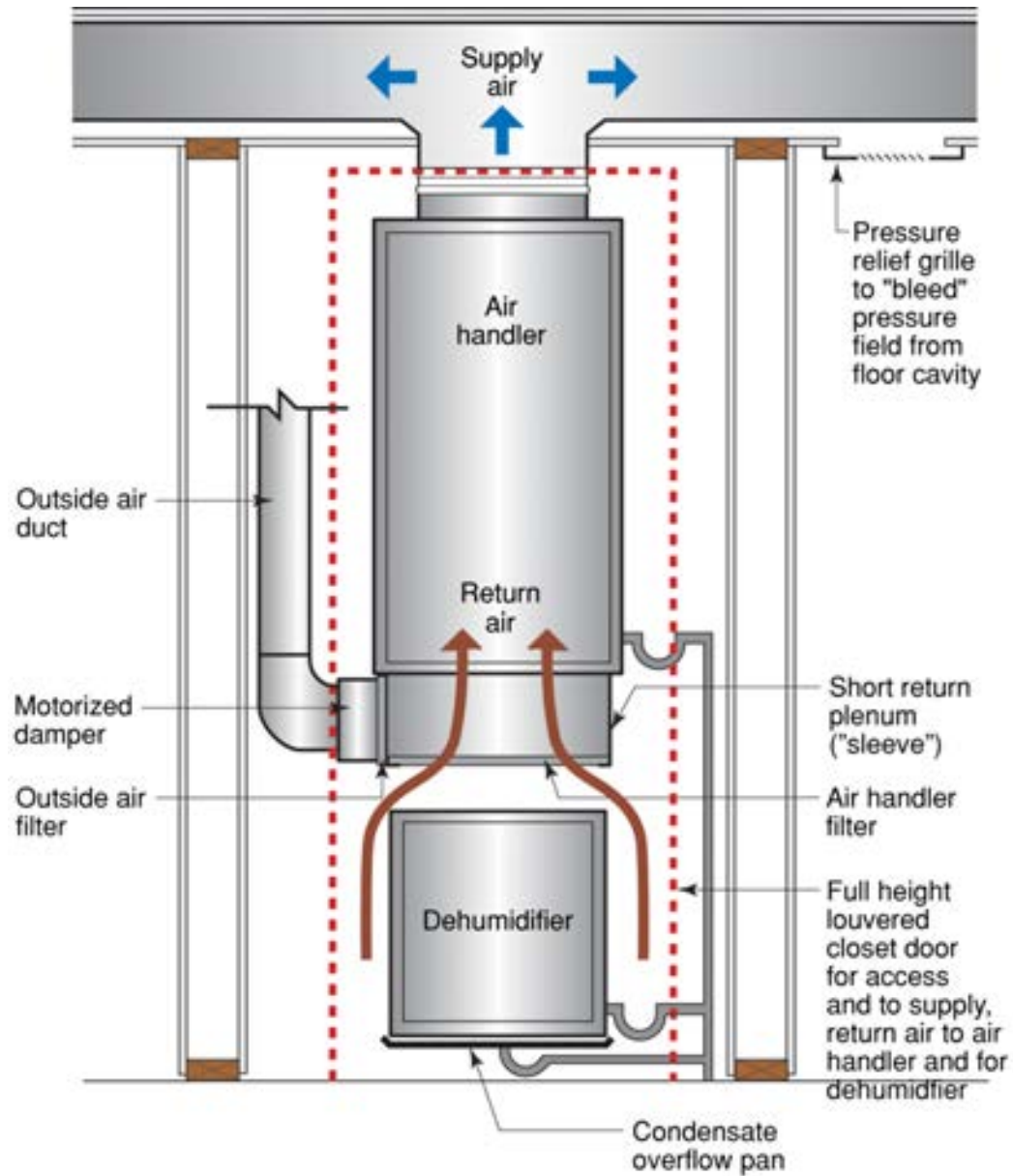



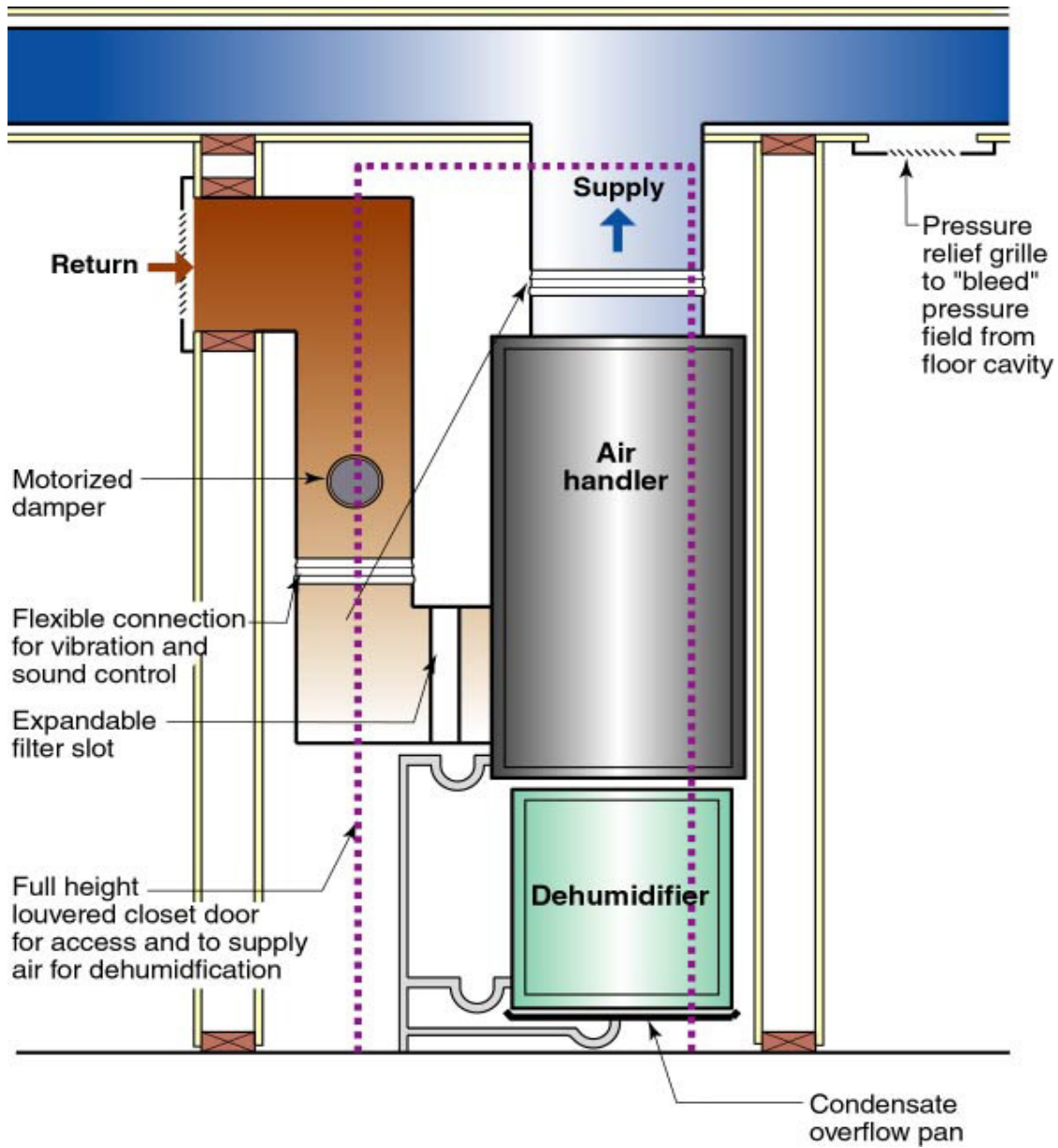

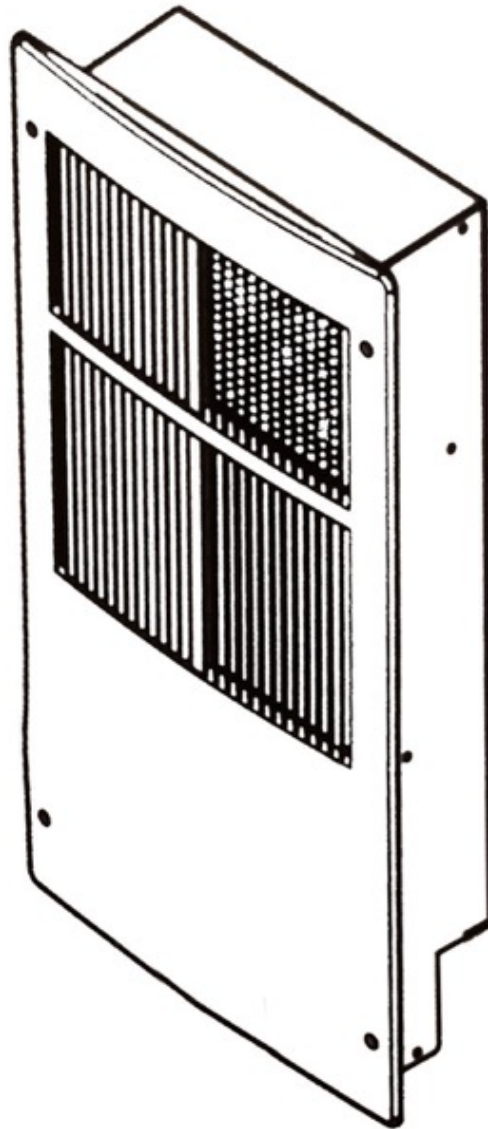

ASHRAE Standard 62.2

0.03 cfm/ft² plus 7.5 cfm/occupant

IRC/IMC

0.01 cfm/ft² plus 7.5 cfm/occupant

30 percent credit for balanced/distributed

2500 ft² 3 bedroom (occupancy 4)

ASHRAE 75 cfm + 30 cfm = 105 cfm

IRC/IMC 25 cfm + 30 cfm = 55 cfm (or 38.5 cfm)

